

**Walter P. Reuther Library, Archives of Labor and Urban Affairs
Application to the National Endowment of the Humanities
Sustaining Cultural Heritage Collections: Planning Grant**

Conservation and Environmental Condition Assessment

Appendices

Appendix A: The Smith Group / Proposal	20
Appendix B: The Smith Group / Archives and Collections Care	26
Appendix C: Photographs of the Reuther Library.....	66
Appendix D: Photographs of Endangered Collections.....	70
Appendix E: Floor Plans	73
Appendix F: Selected Collection Storage Area Climate Data.....	79
Appendix G: Recent Works Citing Reuther Library Collections.....	83
Appendix H: Letters of Support	96
Appendix I: Resumes of Principal Participants.....	105

October 26, 2015

Ms. Christa Azar, R.A.

Project Planner

Wayne State University

Facilities Planning & Management Design & Construction Services

5454 Cass Avenue

Detroit, MI 48202

Subject: Collection Environment Conditions Assessment and Recommendations for the Walter P. Reuther Library of Labor and Urban Affairs

Dear Ms. Azar,

On behalf of SmithGroupJJR, Inc., I am pleased to submit this proposal for architectural and engineering services necessary to perform a Collection Environment Conditions Assessment for the Walter P. Reuther Library of Labor and Urban Affairs.

The following is our understanding of the project and the scope of services to be provided.

UNDERSTANDING OF THE PROJECT

The Walter P. Reuther Library of Labor and Urban Affairs, Wayne State University, Detroit MI houses the largest and most comprehensive labor archives in North America. It is also the home to the Wayne State University Archives. The Library's collections are vast, approximately 75,000 linear feet the majority of which are stored on site. The collections are comprised of personal papers, organizational records, 2 million photographic images on various media, 7,500 moving images, 12,000 sound recordings, 12,000 rare and non-rare books, periodicals and union contracts and some oversized three dimensional objects. The collections span from late 19th to the 21st centuries but, are predominately 20th century.

The library is a public institution, open Monday thru Friday for at least six hours each day. Recent attendance records show that the library accommodates approximately 1,200 researcher visits per year.

The building was originally constructed in 1975. An addition was added in 1991. It is a four story structure with a skylight covered central atrium. The buildings were designed to house the collections, however the building envelope and the building systems (MEP, lighting etc.) appear to be unable to maintain acceptable conservation environments for the variety of materials comprising the collection.

As such there is considerable concern regarding the continued deterioration of the collection and potentially unreparable damage to this valued cultural asset.

WSU has requested a Conservation Environment Conditions Assessment to identify sustainable alternatives for improving the collection environments and unique operational challenges of the collection.

SCOPE OF SERVICES

Evaluation of the building and systems needs for an improved protection of the collection must start with an understanding of the existing building construction and system capabilities. The building systems must be capable of providing the basic climate control needs for the conservation environment as well as related utilities, power, lighting and control for critical library systems, and occupant comfort. Likewise, the building must adequately protect the collection from the elements and perhaps more importantly, must be able to with stand the potentially deleterious effects of high humidity conservation environments.

With an understanding of the existing building and systems conditions and the desired collection environments to be achieved we will have base knowledge necessary to develop alternative strategies for improved collection protection. We propose the following tasks:

TASK ONE: EXISTING CONDITIONS ASSESSMENT

Through the use of existing documentation, visual inspection and non-invasive testing/modeling (IR Thermography and Hygrothermal Evaluations) we will assess the current conditions of the building systems and building envelope. As a result of the assessment we will determine temperature and humidity condition ranges and extremes that the building is currently capable of supporting. This assessment will be limited to primary building system elements and macro planning issues, and is not intended to provide a comprehensive repair or replacement guide or listing.

The Conditions Assessment will additionally evaluate the ability of the existing MEP and related control systems to support or provide for the desired range of preservation environments. Inasmuch as assessing the existing MEP systems requires that certain assumptions be made by SGJJR regarding existing conditions, and because some of these assumptions may not be verifiable without the Owner expending substantial sums of money for physical testing or examination, the assessment will be limited to evaluation of existing available equipment model and capacity documentation, on-site visual review of the systems, detailed discussion with operations staff and related engineering approximations.

Deliverables: Summary report of findings

Schedule: 3 weeks

TASK TWO: UNDERSTANDING THE COLLECTION

Through the use of existing documentation, visual inspection and meetings with the Library Staff we will develop an overall understanding of the collection. We will endeavor to understand the types of media, their quantities; current storage systems; relative storage locations within the building; frequency of use and current challenges. We would also highly recommend that the University provide an assessment of the current condition and valuation of the collection by a properly credentialed third party source.

Development of this level of understanding will be crucial in delineating alternatives for consideration.

Deliverables: Summary report of findings

Schedule: 2 weeks

TASK THREE: COLLECTION ENVIRONMENT AND SUSTAINABILITY GOAL SETTING

In a workshop specifically design and facilitated by SGJJR we will review the findings of TASKS 1 and 2; review the University's sustainability goals; national and internationally recommended collection environments standards; review current trends in sustainable preservation environments with an emphasis on defining sustainability goals and collection environment targets for the library and individual collections.

Deliverables: Summary report of findings

Schedule: 1 week

TASK FOUR: ALTERNATIVES

Based on the results of Tasks 1-3 we will develop good, better and best alternatives for consideration. Such alternatives may range from minor MEP system adjustments and / or collection storage strategies to wholesale MEP systems upgrades and / or architectural envelope renovations. Each alternative when presented will include an order of magnitude of cost and schedule for implementation and an assessment of the long term improvement / risks to the collection and a summary of the sustainable measures employed.

Deliverables: Schematic Drawings, Narrative, Order of Magnitude Cost, Order of Magnitude Schedule and Improvement /Risk Matrix for each alternative.

Schedule: 4 Weeks

TASK FIVE: RECOMMENDATIONS AND FINAL REPORT

Final report compiling all of the information developed in Tasks 1-4 with our final recommendations.

Deliverables: Five (5) bound color copies and electronic files

Schedule: 2 Weeks

ASSUMPTIONS

SmithGroupJJR makes the following assumptions in the development of this proposal:

- a) WSU will provide a single contact person who will have the authority to provide direction and approve project information. SmithGroupJJR will report to this individual.
- b) SmithGroupJJR will designate a single contact person.
- c) All project direction and information will pass through these designated single points of contact.
- d) SmithGroupJJR will take best advantage of the existing database of information for this project..
- e) WSU does not have any Owner Provided Consultants at this time.
- f) SmithGroupJJR will be compensated for labor, overhead and corporate fees for changes to previously approved work and additional scope of work.

OWNER RESPONSIBILITIES

To assist SmithGroupJJR in completing the Scope of Services, WSU, will assume the following responsibilities:

- a) Provide SmithGroupJJR with all available existing project data (architectural, structural, mechanical, electrical, civil, specifications, as – built drawings etc.) owner studies and desired product literature as soon as practical after award of project.
- b) Provide SmithGroup JJR with existing temperature and humidity data and utility bills for the last 12 months.
- c) Make the site available for field investigation and assessment of existing conditions, including having operational personnel present to provide access to secured spaces and panel boards and / or electrical gear.
- d) Actively assist SmithGroupJJR in the review of the collection materials through the assistance of the Owner's Archivist or Conservator to provide detailed access to the collection.
- e) Actively participate in the decision-making process, including timely reviews, to maintain project schedules.

SCHEDULE

We understand that funding for this proposal (all or parts) may be dependent on award of a grant from the National Endowments for the Humanities. We also understand the notification of award and subsequent approval to this proposal may not occur until the 3rd quarter of 2016. SmithGroupJJR will work with WSU to develop a mutually agreeable project schedule at such time of award.

CONSULTANTS

SmithGroupJJR, does not anticipate the use of any outside consultant(s) at this time.

If additional consulting services are necessary a scope of services and cost will be presented for approval prior to performing any work. The related work will commence only upon written approval.

PROFESSIONAL SERVICES FEE

The Client shall compensate SmithGroupJJR for the Scope of Services outlined billed on an hourly basis in accordance with the WSU Preferred Vendor Fee Schedule. The estimated sum for these services is \$75,200 (Seventy Five Thousand Two Hundred Dollars). The following is an itemized summary of the estimated fees per task:

TASK ONE – CONDITIONS ASSESSMENT	\$27,000
TASK TWO – UNDERSTANDING THE COLLECTION	\$11,600
TASK THREE – CONSERVATION ENVIRONMENT AND SUSTAINABILITY GOAL SETTING	\$4,200
TASK FOUR – ALTERNATIVES	\$25,000
TASK FIVE – RECOMMENDATIONS AND FINAL REPORT	\$7,400

SmithGroupJJR reserves the right to renegotiate our fee if the project schedule duration is lengthened beyond that indicated in this document, or if the scope of work is modified.

REIMBURSABLE EXPENSES

The following cash costs shall be reimbursable only upon written approval from WSU:

1. Reproduction of drawings, specifications and reports and reproducible (Mylar, etc.) reproductions of drawings per our rate schedule.
2. Postage and express delivery charges.
3. Models, renderings, photography and other special presentation material for other than the Architect's own use.
4. Regulatory Agency review fees.
5. Employment of, with Client's prior approval, special consultants other than those listed in this proposal.

Compensation for these reimbursable expenses will include a 10% management fee.

ADDITIONAL SERVICES

Requests for additional services or staff will be documented by SmithGroupJJR (if given verbally), and the work will commence upon Client's written approval of an estimated fee for that effort. For additional services, the Client shall reimburse SmithGroupJJR a fee based on the hourly costs established in the PVMA

PAYMENTS

Invoices will be prepared monthly on the basis of percentage of completion. All payments due to SmithGroupJJR shall be made monthly upon presentation of the statement of services rendered.

This document will serve as an agreement between us, and you may indicate your acceptance by signing in the space provided below and returning one (1) signed copy for our files.

Signature

Name & Title

Date

We appreciate the opportunity to submit this proposal and look forward to continuing our work on this project. If you have any questions on this proposal, please contact me at (313) 442-8318.

Sincerely,

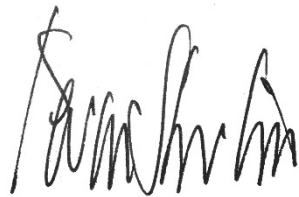

Kevin Shultis, AIA, LEED AP bd+c
Vice President, SmithGroupJJR



Preserving Culture.

Archives and Collections Care

SMITHGROUP JJR

A Bit About SmithGroupJJR /

SmithGroupJJR is one of the largest architecture, engineering and planning firms in the U.S. With a staff of over 900, we specialize in the cultural, workplace, higher education, healthcare, and science and technology sectors. Our integrated practice offers depth in all disciplines serving the built and natural environment, including architecture, engineering (civil, structural, mechanical, electrical and plumbing), landscape architecture, urban design and environmental science.

While recognized for innovation, SmithGroupJJR's integrated design approach is also characterized by detailed attention to owner objectives and sensitivity to project context. With a core commitment to design excellence, SmithGroupJJR has the special expertise and experience to meet unique project challenges. We are a team of gifted, energetic, and creative architects, interior designers, and engineers. As design leaders, we work with our clients to create direct responses to unique imperatives and opportunities, transforming vision and mission into built form.

Our Cultural Studio comprises talented architects, planners, interior designers, and engineers dedicated to the design of cultural and educational facilities. The studio has become a major force in the design of cultural spaces for national projects and has a portfolio that is one of the best in the country.

Founded in 1853, we know the meaning of longevity, integrity and adaptability. Today, as a multidisciplinary design firm, we continue to grow in the U.S. and internationally. SmithGroupJJR clients benefit from the technical expertise, creativity and high level of quality that our integrated practice brings.

As one of the nation's leading sustainable design firms, SmithGroupJJR has long been in the forefront with innovative strategies for resource efficiency. In fact, sustainable design has always been central to our corporate culture and sense of professional responsibility. Given our dedication to environmental stewardship, we incorporate sustainable design solutions into all our projects and have adopted the rigorous energy targets of the Architecture 2030 Challenge.

Focused and Dedicated Cultural Practice

SmithGroupJJR's Cultural Studio is focused on the transformation of the cultural institution. The collective design aesthetic is derived from the goals established with the client, their stakeholders and the interpretive messages that help shape the visitor's experience.

The studio has become a major force in museum and collection facility design for some of the nation's most prestigious institutions with a portfolio of award-winning museum and archival projects that is one of the best in the country.



Cultural Experience

We are aware that in the current economic environment, cultural institutions must compete for money. They need to be a step ahead of the internet world to attract young visitors. Survival depends upon creating a balance between an economy of means, learning and excitement, education and entertainment.

SmithGroupJJR's Cultural Studio is focused on this transformation of the cultural institution. The Studio, operating out of the Detroit and Washington, DC offices, comprises talented architects, planners, interior designers, and engineers dedicated to the design of cultural and educational facilities. The collective design aesthetic is derived from the goals established with the client, their stakeholders and the interpretive messages that help shape the visitor's experience.

The studio has become a major force in museum design for some of the nation's most prestigious institutions with a portfolio of award-winning museum and archival projects that is one of the best in the country. We have helped launch a series of successful new institutions such as the International Spy Museum and the Normandy American Cemetery Visitor Center. These projects reflect our knowledge of the complex technical and operational issues that cultural institutions face in today's competitive environment and recognize our ability to implement design intuitively creating built environments that inspire, educate and entertain.



The following are some of the benefits we offer:

Integrated Design

Our team includes professionals with significant expertise beyond the traditional disciplines of design including professionals with graduate degrees in conservation, collections management and theater arts. These added dimensions allow our team to understand more fully the purpose and nuances of projects for cultural institutions.

Award Winning Relevant Experience

We have an extensive award-winning portfolio of

- Museums and Visitor Centers
- Visual Arts and Fine Arts Facilities
- Archives and Collections Care Facilities
- Performing Arts Facilities

Museum Conservation Design Experience

We are highly knowledgeable and experienced in the special design requirements of museum, exhibit and archival spaces, and have a strong working knowledge of the conservation needs of a diverse range of collection materials.

Sustainable Design Leaders

With more than 350 LEED Professionals Accredited Professionals in our offices, we are committed to "Green" initiatives. We have 153 LEED Certified or Registered projects and designed the first LEED Platinum building in the country - The Chesapeake Bay Foundation Philip Merrill Environmental Center. In 2008, the USGBC selected SmithGroupJJR as its first firm of the year. Because the Philip Merrill Center was so successful, SmithGroupJJR was recently hired to design a world class environmental center that will serve as the nexus for their expanding Hampton Roads environmental education, advocacy, restoration and community programs. This project will pursue the "Living Building Challenge" standards of the International Living Future Institute and exceed the U.S. Green Building Council's LEED® Platinum level rating.

SmithGroupJJR is Known for Collaboration

We have deep experience in community outreach and listening, and are accustomed to working with multi-stakeholder clients.

Services

Building on more than 160 years experience and thousands of completed projects, SmithGroupJJR has developed a wide range of expanded services to serve our cultural clients, all intended to ensure a successful project.

Traditional Services

- Architecture
- Interior Design
- MEP Engineering
- Historic Preservation & Adaptive-Use
- Sustainable Design
- Landscape Design

Extended Services

- Museum & Archival Master Planning
- Performing Arts & Fine Arts Master Planning
- Cultural District Planning
- Facilities Planning & Programming
- Lighting Design
- Building Technology Services



Additional Services | Lighting Design

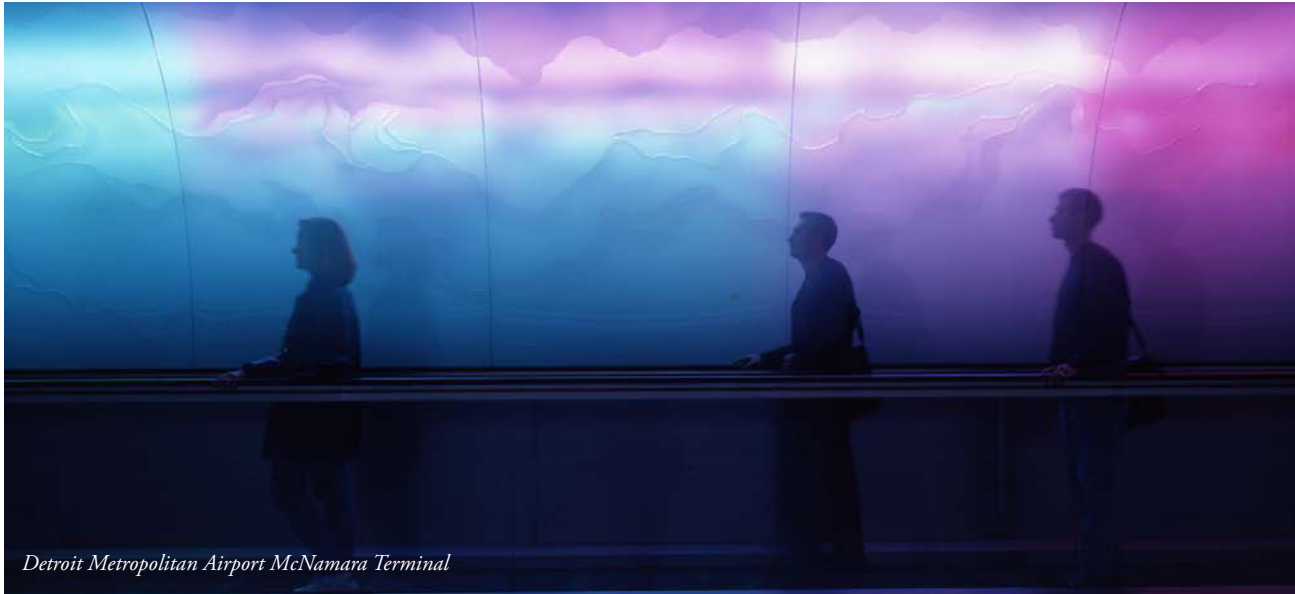

The Lighting Design group supports SmithGroupJJR offices nationwide, and independently serves as a consultant to outside clients, providing specialized solutions to challenging architectural environments. Our expertise enriches the design fabric of projects ranging in size from residential to large-scale corporate, and includes diverse project types such as museum, stadium, and historic renovation.

SmithGroupJJR has been recognized for its consistent design excellence and is among the most highly honored lighting design teams in recent years, winning over 30 local, regional, and international awards such as the lighting design's highest honor, the coveted International Illumination Design Award - Edwin Guth Memorial Award of Distinction, which "honors extraordinary achievement in lighting design."

Design Philosophy

We realize the critical role that lighting design plays in evoking emotions in architecture. In response, we strive to raise awareness within architecture by using lighting design to clarify perception of the built environment. We believe in the creation of environments that contribute to the birth of emotions. Human perception is the open canvas onto which we lay an arrangement of components with the distinct objective to trigger a reaction, passive or active.

We integrate design solutions that establish coherent results across disciplines. By blending the art and science of lighting, we develop and deliver seamless solutions whose

boundaries of form and function interweave effortlessly. We assume an active role to promote lighting as a crucial component in our surroundings. The clarity of our lighting solutions is the result of commitment to our client's aspirations and is the assurance that our solutions will embody the essence of their vision.

Design Process

We view our interaction in the design process as a malleable exercise that engages both our clients and design team in a productive dialogue with the shared goal of establishing a platform for tangible solutions that exceed expectations.

Often times the design character of architectural spaces or elements finds its roots in a metaphorical concept that provides a "reason for being." By focusing on this conceptual design intent, budget and constructability constraints can be addressed without compromising the design.

We view our expertise in lighting design as a valuable and integral component in shaping the visual nature of architectural environments. Through lighting, we affect the perception of spaces by understanding and implementing the following: hierarchy of brightness, psychological response to light, spatial recognition, material behavior and color theory.

Translating this understanding into more quantifiable measures grants the assurance that the final design meets the original intent while achieving established standards.

Tools and Methods

Critical to meeting the expectations of the lighting design concept is translation of concept to reality. To facilitate our design process, we utilize a number of techniques including computer based three-dimensional modeling and physical mock-ups of special conditions. These tools and methods eliminate guesswork and provide substantiation for our designs.

We are proficient with various lighting calculation programs, including Lightscape, one of the most advanced and powerful programs in the industry.

Lighting and Collections Care

We provide artistic, highly flexible and functional illumination designs for collection care environments that address ultraviolet radiation and reduce overall collection exposure to the harmful aspects of artificial and natural light. We know that daylight and transparency are critical design features to the aesthetics and experience of many designs and are critical to the proper exhibit of collections in some cases. However, ultraviolet light must be carefully managed in all collection care environments.

Our lighting designers have extensive skills in daylighting design and solar analysis. Utilizing computerized design programs such as DaySIM and Radiance, we routinely develop and demonstrate the resulting solar loads, exposures, and irradiation patterns and intensities that result from different window designs to properly judge solar impact on the exhibit and collection.

Sustainability and Lighting Design

Lighting also plays a large role in sustainable design with substantial effects on energy efficiency and the quality of the work environment. Our expertise allows us to address lighting issues that affect sustainable design, including; energy efficiency, utilization of daylight, light pollution, light trespass, and lighting control.

Controlled daylight is an often under-utilized resource that can be used to offset the demand for artificial lighting, increase building energy efficiency, improve worker productivity, and increase worker satisfaction.





Our approach to a project is rooted in the firm's basic design philosophy and in the people and processes we bring to a project. For us, every project is distinct, and its solutions lie in the needs and mission of the client, underlying economics, the character, and context of the site.

SmithGroupJJR's work does not espouse any single design style, but strives to find that which is unique and important to a given project. The form and image comes from the particular client, project, and the specific needs and place for which a project is designed. Design is pursued rigorously with an intellectual search for solutions to the clients' problem and through artistic expression. A collegial design process in our office allows the best ideas to rise to the top from every team member.

We do not bring a formulaic preconception to our work. We bring solid experience, which we place at our client's service. Our principals and staff are wedded to this philosophy, and they recognize that success in this approach comes from a close communication with our clients.

Approach

Fulfilling our clients' needs with superior design services that lead to memorable design products is of central importance in SmithGroupJJR's design philosophy. As a result, our firm treats planning and design as a process in which the client is collaborator. We foster a high level of

client involvement in the design process to ensure that our team gains a complete understanding of the programmatic intent, budget, and required schedule. The results are projects that reflect sensitivity to the physical context, the character of the client, and the goals of the project.

The strength of SmithGroupJJR lies in our ability to resolve the multiple complexities of today's projects. We recognize that each project has a unique set of parameters, and we are committed to solving all problems without compromising the project's integrity. Our goal is to express the specific site, program, and context in a fresh, efficient, and cost-sensitive solution that aspires to become meaningful design.

It is important to us to build beautiful and functional works, but equally important is implementing the designs so that they will stand the test of time. Our use of quality materials, proven construction techniques, and in-house quality assurance program ensures that the projects are built correctly.

We believe that we are stewards of the natural and built environment. While sustainability has caught on recently throughout the design community, it has been a hallmark of our practice since 1961 and continues to permeate everything we do. Good planning and design incorporates sustainable features in all elements from material selection to how we treat rain water.

Consistent with this approach, our principals, key associates, and design staff have worked with clients and stakeholders to achieve high quality planning and site design projects that meet each client's need and program in an exceptional way.

Site Selection

Many of our clients look to us to assist in the decision making process as they look for new headquarters, support or regional facilities. Our land planning and design team, including planners, civil engineers and architects have helped dozens of clients in the areas of health care, education, corporate work place and government find the most suited location of facilities using a proven process that allows clear informed decisions on facility locations to be made.

Our process begins with the development and definition of the program, adjacencies, demographics, employee base, customer/user locations and service area requirements essential to the successful operation of the facility. We then use this information and work with the client to establish the evaluation criteria that will be used to assess each site and compare sites against each other. As we develop the criteria, we work with the client to

determine the most feasible sites/locations to be evaluated, based on the initial criteria, land holdings, developer opportunities or other methods that lead to available and potential sites. Each site is visited, documented and a site evaluation is made as to the availability of utilities, access/ egress, image, location to major roadways and highways, natural features, orientation, storm water management capabilities, zoning and ability to meet the program and operational needs of the proposed facility. A conceptual land plan will be developed for each site, unique to each site making the best use of its features and configurations using the program and other criteria established. Each site is then evaluated using the criteria, and ranked based on a weighted system reflecting the most important versus least important criteria as defined by the client. The alternatives are compared and evaluated in a work session with the key decision makers of the client, with the goal of determining the most feasible site. Then, to test the validity of the evaluation results, the preferred site is tested further with more detailed site alternatives, and these are then presented to the client with a recommendation whether this is the best suited site for the client needs.

The results and recommendations are documented for the clients use in presenting to its board or decision makers.



Indian Springs Metropark Environmental Discovery Center

Commendation and Recognition

Cranbrook Institute Art Museum & Library Addition, Bloomfield Hills, Michigan

- 39th Annual Interior Design Award (International), International Interior Design Association (IIDA), 2012
- Illumination Award of Merit, Illuminating Engineering Society of North America (IESNA), 2012
- Honor Award, Masonry Institute of Michigan (MIM), 2012
- Light & Architecture Design Award (International), *Architectural Lighting*, 2012
- Brick in Architecture — Gold Award, Commercial, Brick Industry Association, 2012

International Spy Museum, Washington, DC

- Outstanding Achievement Award, Thea Awards, Themed Entertainment Association, 2005
- Business of the Year, DC Chamber of Commerce, 2003
- Best Renovation: Historic Restoration or Preservation, National Association of Industrial and Office Properties, 2003
- Catalyst Award, Washington (DC) Chapter AIA, 2002
- Downtown DC Momentum Award, Program or Project, Downtown, DC Business Improvement District, 2002

Library of Congress National Audio/Visual Conservation Center, Culpeper, Virginia

- Overall Project of the Year, Mid-Atlantic Construction, 2007
- Institutional Project of the Year, Mid-Atlantic Construction, 2007
- Award of Excellence – Institutional Facility Over \$20 Million, National Association of Industrial and Office Properties (NAIOP) – Northern Virginia Chapter, 2007

Montgomery College Cultural Arts Center, Takoma Park, Maryland

- Public Building of the Year, AIA Maryland, 2010
- Award of Excellence in Institutional Architecture, AIA Northern Virginia Chapter, 2010
- Metalmag “Interiors” Architectural Award, 2010
- Award for Excellence in Architecture, Washington (DC) Chapter AIA, 2009

National Hurricane Museum and Science Center, Lake Charles, Louisiana

- Progressive Architecture (P/A) Award (International), *ARCHITECT*, 2012

National Postal Museum, Washington, DC

- National Honor Award in Interior Architecture, American Institute of Architects, 1999
- Federal Design Achievement Award, National Endowment for the Arts Presidential Design Awards, 1995
- Award for Excellence in Interior Architecture, Washington (DC) Chapter AIA, 1994
- Inform Award, Virginia Society AIA, 1994

Normandy American Cemetery Visitors Center, Normandy, France

- International Architecture Award, The Chicago Athenaeum: Museum of Architecture and Design, the European Centre for Architecture Art Design and Urban Studies, and Metropolitan Arts Press, 2008
- American Architecture Award, The Chicago Athenaeum: Museum of Architecture and Design, the European Centre for Architecture Art Design and Urban Studies, and Metropolitan Arts Press, 2008
- Honor Award, AIA Maryland, 2007
- Honor Award, Virginia Society AIA, 2007
- Award of Excellence, Washington (DC) Chapter AIA, 2007
- Award of Excellence for Conceptual/Unbuilt, Northern Virginia AIA, 2005
- Merit Award, Virginia Society AIA, 2004

Science City at Union Station, Kansas City, Missouri

- Preservation Honor Award, National Trust for Historic Preservation, 2002
- Honor Award for Architecture, Kansas City AIA Chapter, 2000
- Public Works Project of the Year, American Public Works Association, 2000
- Reconstruction Project Award for Adaptive Reuse, Building Design & Construction Magazine, 2000

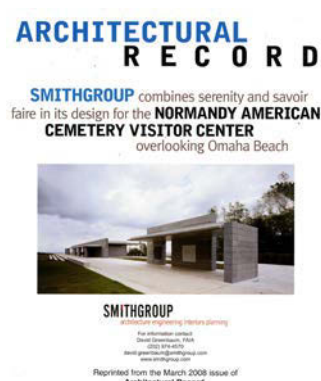
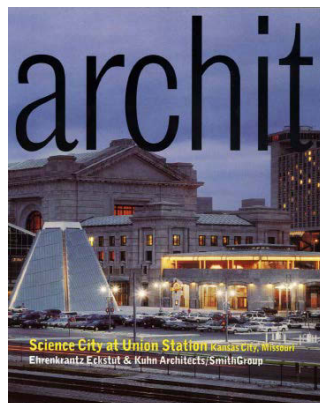

In Good Company

American Battle Monuments Commission **Anacostia Museum/Smithsonian Institution** Architect of the Capitol **Army Navy Center** Arizona Sonora Desert Museum **Carnegie Institution of Washington** Cranbrook Art Museum Corcoran Gallery of Art **Dan Ryan Woods Nature Center** Delaware Museum of Natural History **Desert Botanical Garden** Detroit Institute of Art **Detroit Symphony** Flint Cultural Center **GALA Hispanic Theatre** Henry Ford Museum & Greenfield Village **Indian Springs Metropark** International Spy Museum **John F. Kennedy Center for the Performing Arts** Kiplinger Washington Editor's Gallery **Levine School of Music** Library of Congress **Long Beach Aquarium** Madame Tussauds **Maryland Historical Interpretive Center** Montgomery College Muskegon Museum of Art **Mystic Seaport** National Academy of Sciences **National Building Museum** National Gallery of Art **National Hurricane Museum** National Museum of African American History and Culture Smithsonian Institution National Museum of American History/Smithsonian Institution **National Museum of Natural History/Smithsonian Institution** National Museum of the American Indian/Smithsonian Institution **National Museum of the United States Army** National Music Museum and Center **National Park Service** National Postal Museum Smithsonian Institution & U.S. Postal Service **National Zoological Park Smithsonian Institution** Northern Virginia Community College Science City at Union Station St. Mary's College of Maryland **The Mariners' Museum** The Washington Ballet University of Florida **U.S. Botanical Garden** U.S. Fish & Wildlife Service **U.S. National Archives & Records Administration** Urban Institute of Contemporary Art **Washington National Cathedral** Western Michigan University West Virginia University **White House Historical Society** Wisconsin State Historical Society Yavapai Prescott Indian Tribe





Clients:

- **Smithsonian Institution**
 - National Museum of American History Star Spangled Banner Conservation Lab
 - National Museum of American History Archives
 - National Museum of American History Dibner Library and Archive
 - National Museum of Natural History Museum Support Center
 - National Museum of American Indians Cultural Resources Center
 - National Postal Museum
- **National Archives and Records Administration**
 - Reagan Presidential Library
 - Carter Presidential Library
 - Hoover Presidential Library
 - US Customs House Archive
 - National Personnel Records Center
 - Nixon Library and Archive
 - Southwest Regional Archive
 - University of Missouri Kansas City
- **Library of Congress**
 - National Audio Visual Conservation Center
 - John Adams Library
- **American Type Culture Collection**
- **Armed Forces Institute of Pathology**
- **Baylor University Rare Book Collection**
- **Catholic University of America**
- **Cranbrook Institute**
- **Detroit Institute of Arts**
- **Indiana University Rare Book Collection**
- **National Gallery of Art**
- **National Museum of the United States Army**
- **Newark Museum**
- **UCLA Film Archive**
- **University of Michigan Clements Library**
- **USDA National Agricultural Library**
- **USS Monitor Center at Mariners' Museum**
- **West Virginia University Art Museum**
- **Wisconsin State Archives**

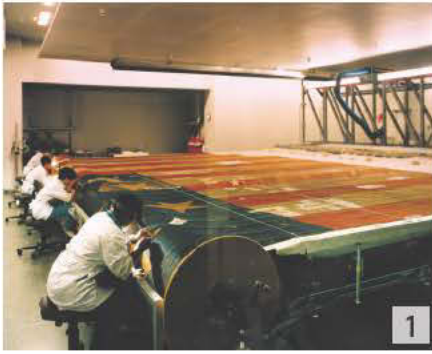

SmithGroupJJR is highly knowledgeable and experienced in the special design requirements for various types of collection care facilities. We have been entrusted with some of our nation's most important documents, artifacts and collections:

- A museum and conservation building to honor our nation's soldiers and tell their story
- A space to protect Jeffersonian texts
- A lab to restore the Star Spangled Banner
- A conservation facility for the turret of a legendary Civil War ironclad
- A home for over 800,000 Native American artifacts
- An archival storage facility to protect the film, video and recorded sound collection of the Library of Congress
- An archival records storage and conservation facility to house the nation's Official Military Personnel files

The care and protection of the collections must be the first and foremost design criteria of any museum, archive, or exhibit development project. To be successful we must ensure that the building enclosure walls, windows and roof system designs are fully integrated with the conservation needs of the collection. Our system designs must address the special environmental needs of each conservation environment and work in harmony with all operational processes. It is critical that the building and its exterior envelope, windows, slab, and roof be designed to withstand the impacts of the humidified conservation environment. These technical design issues can often drive

much of the architectural design for such facilities and dictate renovations of historic structures. Understanding these issues in the beginning of the project is paramount.

We have dedicated a group of architectural and engineering professionals that provide advanced analysis and engineering of building walls, windows, slab and roofing systems, to provide appropriate condensation resistance, mold resistance, pest control, water penetration control, and thermal performance for these critical facilities. We routinely work with historic building enclosures that often have unique protection mechanisms. To address the critical design challenges, we incorporate the application of computerized analysis programs. We use state of the art software such as WUFIpro developed by Oakridge National Labs and the Fraunhofer Institute for Building Physics, THERM developed by Los Alamos National Labs, as well as our own proprietary wall and roof thermal and vapor analysis programs.

From this experience, we have developed a deep respect for our client's collections and a strong understanding and passion for projects whose goal is the preservation of our cultural heritage. By creating places to preserve, protect and display the artifacts and archives that document critical moments in our history, our clients play a vital part in preserving our collective memory, giving future generations the ability to view actual manuscripts and documents so they can experience history in a truly authentic way.

- 1 National Museum of American History
Star Spangled Banner Conservation Lab
- 2 Smithsonian Institution Museum Support
Center
- 3 University of Michigan Clements Library
- 4 National Museum of the American Indian
Cultural Resources Center
- 5 Wisconsin Joint Preservation Storage
Facility
- 6 St. Mary's College Maryland Heritage
Interpretive Center & Anne Arundel Hall
- 7 National Gallery of Art Conservation Labs
- 8 Cranbrook Art Museum & Collections
Building

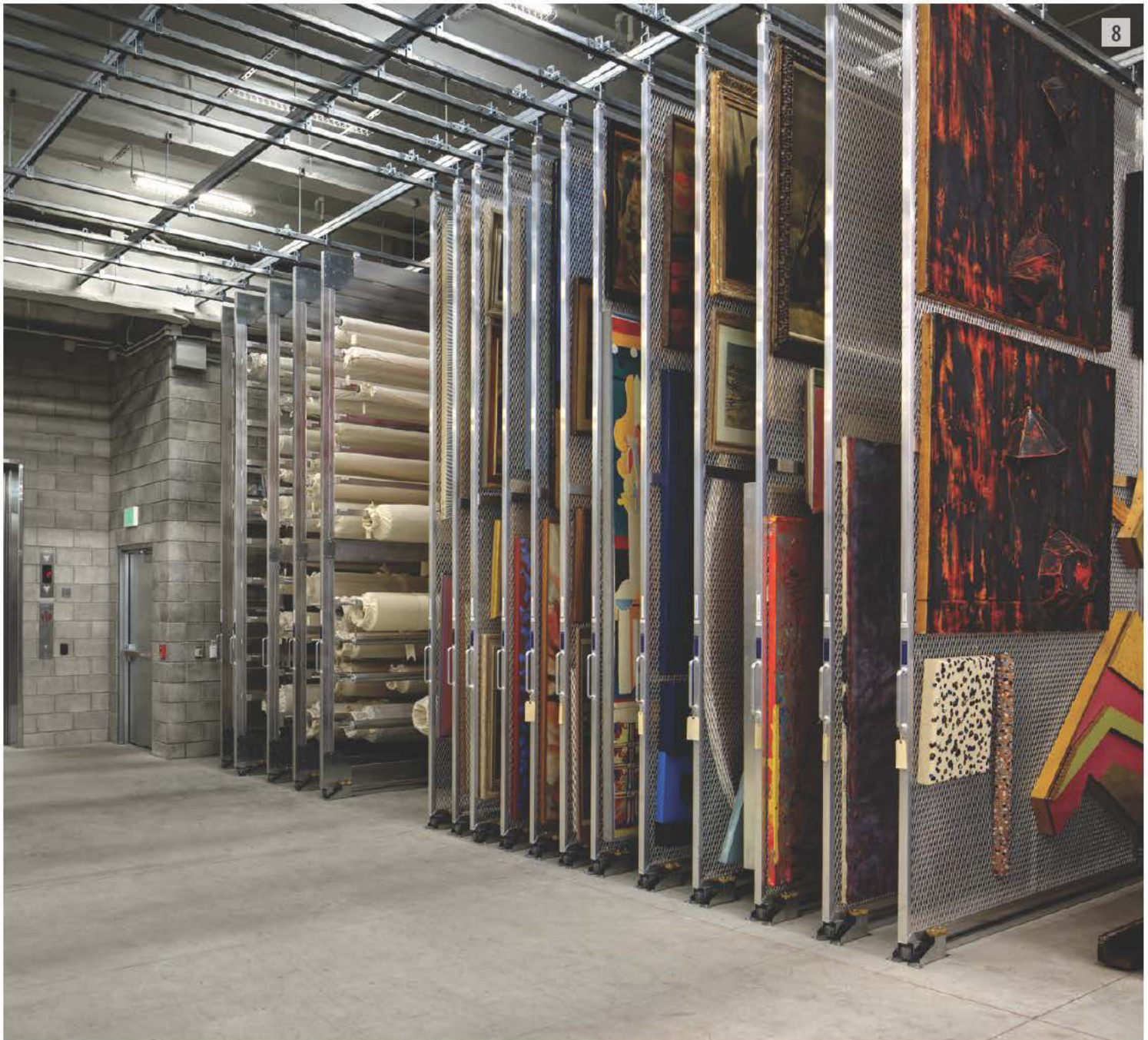



Cranbrook Art Museum Renovation and Collections Building

Protecting the Collection

The care and protection of the collection must be the first and foremost design criteria of any museum, archive, or exhibit development project. To be successful it must be provided that the building and exhibit designs are fully integrated with the conservation needs of the collection and that the systems designs can provide for the special environmental needs of each conservation environment.

It is critical that the building and its exterior envelope, windows, and roof, be designed to withstand the impacts of the humidified conservation environment. These technical design issues can often drive much of the architectural design for such facilities and dictate many of the corrections necessary to historic structures when used for museum facilities. Understanding these issues in the beginning of the project is paramount.

SmithGroupJJR is a national leader in the design of specialized building enclosures that contain extraordinary humidified and/or unique environmental needs. We have a dedicated group of architectural and engineering professionals, within our Cultural Studio, that provide advanced analysis and engineering of building walls, windows, and roofing systems, to provide appropriate condensation resistance, mold resistance, water penetration control, and thermal performance for these critical facilities.

We routinely work with historic building enclosures that often must have unique protection mechanisms provided to protect these valuable structures from the detrimental influences of new applied conservation environments. We incorporate the application of computerized analysis programs to help us solve these critical design problems. We use state of the art software such as WUFIpro developed by Oakridge National Labs and the Fraunhofer Institute for Building Physics, THERM developed by Los Alamos National Labs, as well as our own proprietary wall and roof thermal and vapor analysis programs.

Maintenance of Building Environment

Determining the environmental conditions for each type of media in a collection is an important issue. We work with our clients to tailor solutions to budget, schedule and conservation requirements early in the planning process. We understand the cause and effect relationships of environmental factors such as temperature, humidity, control stability, UV light, and environmental pollutants, to the life expectancy of museum and archive collection materials.

Often the most appropriate environment for certain materials and media can be contrary to the proper care of others. The cold storage most appropriate for color photography, or the reduced humidity cool environment most appropriate for early 1800's paper, are both somewhat contrary to the 70 degree, 50% relative humidity environment desired for museum visitor areas and composite materials. For a facility that combines

museum, archive, and library functions, it is critical to have an excellent working knowledge of the numerous archival and museum standards that can apply, such as the requirements for accreditation by the American Association of Museums (AAM), National Archive and Records Administration (NARA), Society of American Archivists (SAA), and numerous others. We have a depth of understanding of these standards as well as a working knowledge of the physical and chemical mechanisms that cause deterioration of various materials.

Often it is important to maintain several different environments to properly protect and care for collections. The intended use and access of collections, as well as desired exhibiting approaches, can drive a need for different environments and need for transitional spaces to acclimatize materials.

Our experience with projects such as the Smithsonian Institution's Museum Support Center for Natural History, which is four acres of conservation under one roof, as well as the National Museum of the American Indian Cultural Resource Center, and numerous other complex museum and archival facilities, has provided us with the specialized insight to help determine the best application of conservation science to fit programmatic and collection needs.

Processes

For museum facilities, understanding the processes that happen within the building and the needs of special collections and artifacts to be housed there is of primary importance. We pursue a thorough analysis to gain an understanding of the movement of supplies, people, archival materials, and waste through the building. We develop guidelines for appropriate adjacencies, separating clean and dirty processes, to provide a facility which is tailored to the specific needs of the collection.

Building Envelope

Air barriers and vapor retarders help maintain environmental conditions and can be essential in the protection of the building envelope. SmithGroupJJR professionals have authored numerous papers and lectured on the building envelope at the National Institute of Building Science Building Envelope and Thermal Environment Council Symposium. Our team directs careful study of building pressurization, dew point analysis, and moisture migration analysis. This allows us to provide the right details to avoid exterior enclosure condensation, moisture and humidity buildup, and avoid thermal bridges, all of which can increase the possibility of mold growth and deterioration from condensation within exterior wall and roof assemblies.

Humidified facilities in colder or wind-driven rain environments require robust and carefully detailed waterproofing systems to mitigate risk to a collection and to the building assemblies, alike. This is particularly true in locations which may lack access in the future. We have expertise in designing unique, highly specialized building envelopes for collections with a variety of environmental parameters. During the programming phase, the team's intimate knowledge of these issues can provide useful insights with respect to providing the appropriate facilities program.

Building Systems

The design of the mechanical, electrical, lighting, and fire protection systems are critical to the protection and preservation of the collection. These systems must be individually designed and fully integrated with the conservation environments for each archive or museum area. There is no one-size fits all approach or typical system that will adequately serve the diverse needs of a combined facility or provide acceptable energy and operational efficiencies. These systems must also be designed to provide reliability, flexibility, redundancy, and accuracy as they have a direct influence on the protection and preservation of the collections.

Mechanical systems must minimize temperature and humidity fluctuations for most areas. Designs to provide low temperature and low humidity archive spaces often require rigorous mechanical system design, especially in humid environments. Often gas phase filtration, or provisions for its future addition, must be incorporated into the systems design to protect against the effects of environmental pollutants such as sulfur dioxide, nitrous oxides, and ozone.

Lighting must essentially eliminate ultraviolet light but must also reduce exposure to all lighting while providing acceptable exhibit lighting to display works as intended.

Careful attention to fire protection options, and selection of appropriate fire suppression systems for each storage and museum environment, is equally important. We work closely with our clients to develop the MEP and fire protection systems that are right for their collection and that provide the best level of protection and cost.

Select Project Experience





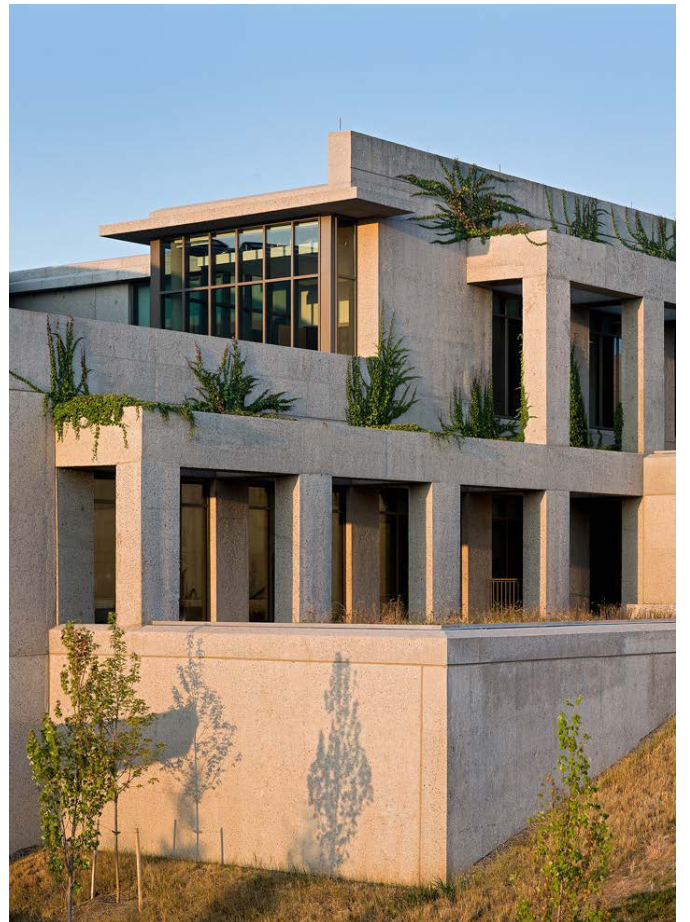

Library of Congress National Audio Visual Conservation Center

Culpeper, Virginia

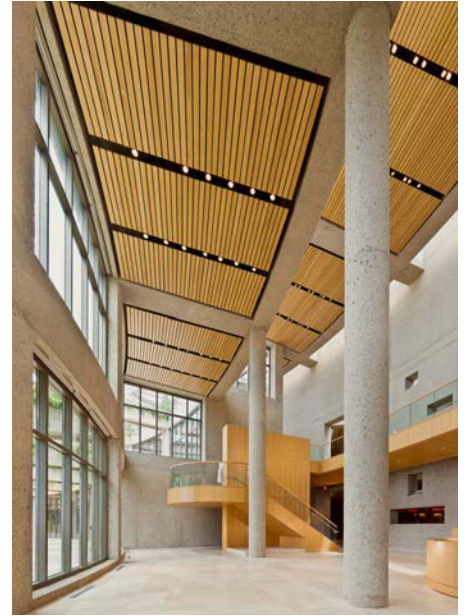

Size

415,000 gsf

Construction Cost

\$120 million

Completion Date

2007

Awards

- Green Innovation Award—Best Green Commercial Project, Virginia Sustainable Building Network, 2008
- Overall Project of the Year, Mid-Atlantic Construction, 2007
- Institutional Project of the Year, Mid-Atlantic Construction, 2007
- Award of Excellence, Institutional Facility over \$20 Million, National Association of Industrial and Office Properties (NAIOP), Northern Virginia Chapter, 2007

SmithGroupJJR responded to the Library of Congress' pressing need for a proper facility for their holdings, incorporating renovation and new construction, to create a new 415,000 sf state-of-the-art facility. This unique facility includes four elements:

- The adaptive re-use of an existing 3-story, reinforced concrete structure built into the hillside of Mount Pony for storage of audio recordings. Sprinkler systems, gas fire suppression systems and new mechanical/electrical systems are incorporated to protect and preserve the extensive collection, which requires cool temperatures and low humidity for storage.
- The Conservation Building that includes a new Digitization Lab and Film Preservation Lab as well as a screening room, conference suite, multi-purpose room, administrative offices and collections processing spaces.
- A new Central Plant that houses the mechanical and electrical equipment to serve the entire campus, adjacent to the existing building.
- The earth-sheltered Nitrate Film Vaults, 120 in all, which, because of nitrate film's volatility, are required to be physically detached from other structures.

All of the new structures have been designed to be sensitive to the rural context and blend into the overall site. They are recessed into the hillside, largely underground with sod roofs for energy conservation and long-term protection of the collection. This configuration also assists in the design of physical security. A sustainability study was conducted to demonstrate that 4 feet of earth cover allows the nitrate vaults to maintain a low temperature for several weeks in the event of a prolonged loss of power.

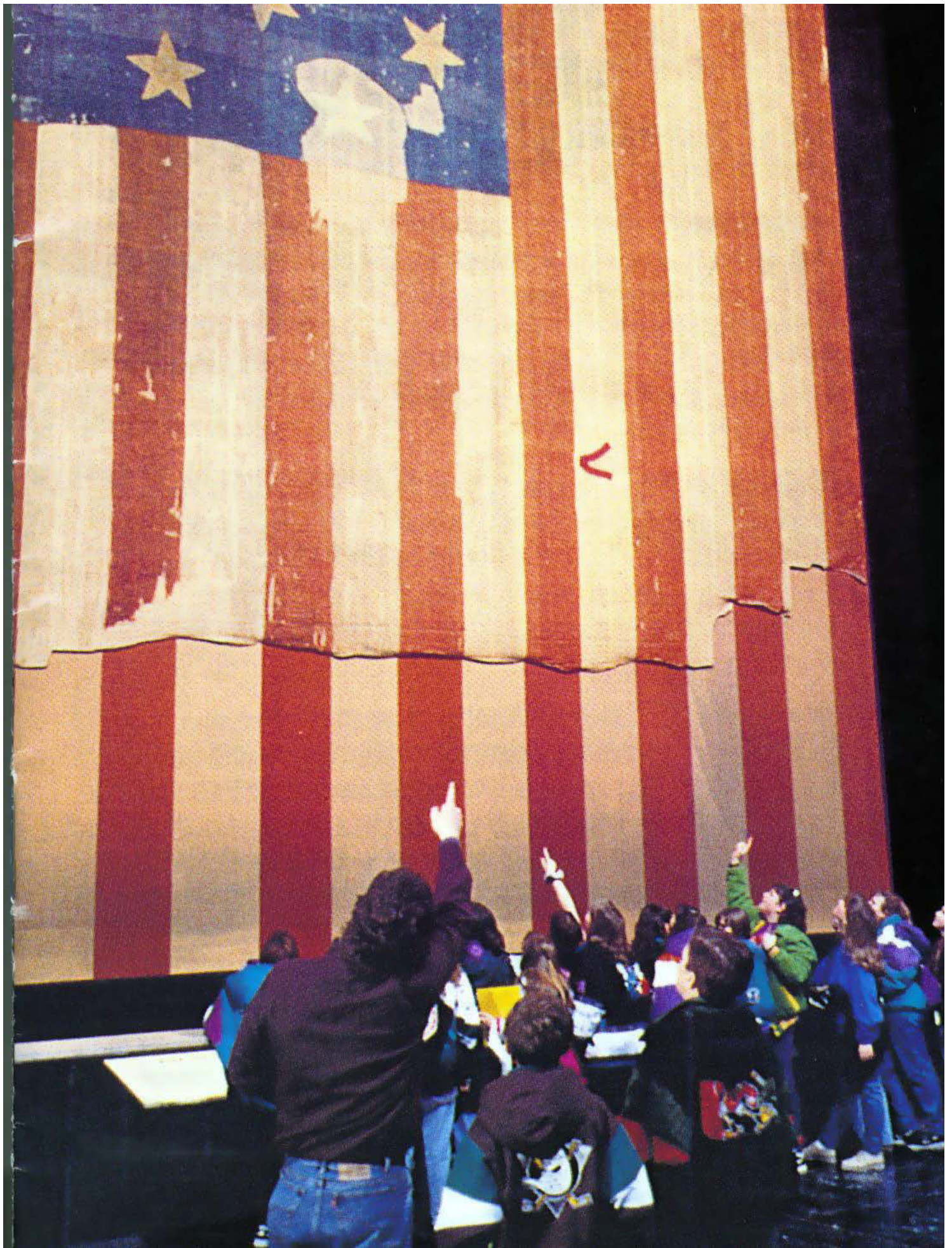

Smithsonian Institution Open-Term Contract National Museum of American History

Washington, DC

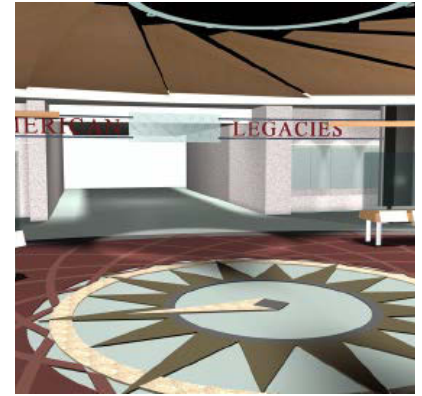
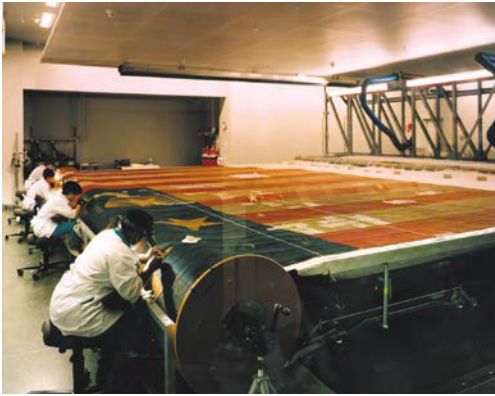

Under an open-term contract with the Smithsonian Institution, SmithGroupJJR provided a range of A/E services from master planning and feasibility studies through design and construction for projects throughout the Smithsonian's many buildings, including the National Museum of American History. Major projects for the NMAH include:

Star Spangled Banner Conservation Lab

This \$2,000,000 project placed our design team in the middle of the conservation process to restore a national patriotic symbol. This was the flag that flew over Fort McHenry during the British bombardment of Baltimore, Maryland, in 1814 and inspired Francis Scott Key to write the poem which became our National Anthem. The 2,500 sf laboratory is also part of exhibit space that explains the history of the flag to museum visitors and the nature of the restoration process. The design was to create an atmosphere of reverence and procession for the visitor's experience and establish a sense of security and trust that the flag is in capable hands.

Flag Hall Renovation and Master Plan

This project centers on reinvigorating the central icon and orientation space of the National Museum of American History. The Star Spangled Banner will be the focus of the flag hall. Plans to integrate a multi-media demonstration about the flag are under development. A circulation master plan was developed to review opportunities to orient the visitor within the museum and help accommodate their needs. The intent of the plan is to strengthen the critical circulation systems and spatial devices while balancing the relationship between exhibits and public space.

American Legacies Exhibit, Welcome Center and Amenities & Life Safety Master Plan

Located on the ground floor of this 450,000 sf historic museum on the National Mall, the Welcome Center and the American Legacies Exhibit define the initial experience of visitors entering the building from Constitution Avenue. The American Legacies exhibit outlines the museum's approach to artifact, museum and history. The Welcome Center is the main orientation vehicle for the museum. The Amenities & Life Safety Master Plan analyzes the changes that have compromised the character and strength of the original building and provides suggestions for readdressing issues of orientation, accessibility and wayfinding to strengthen the visitor's experience of the museum.

Constitution Avenue Fountain Precinct Repairs

SmithGroupJJR provided a public space concept design to reactivate the fountain, make the hardscape accessible for Smithsonian Institution staff and visitors, reduce safety hazards inherent to the original construction (such as honed granite paved surfaces which become slippery when wet) and repair damaged materials within and surrounding the fountain. In consultation with an advisory group of stakeholders representing numerous interests within the Institution, the design team determined that the concept should restore the intent and spirit of the original design of the water effects, ascending axial progression from sidewalk up to the entrance, and plan and materials of the Fountain and its precinct. Findings, analysis, the concept alternatives and recommended design with a cost estimate, were presented in plans, photos, and narratives that clearly explained all the elements to facilitate decision-making. The concept designs included changes required for plumbing and electrical systems, and landscape and site lighting improvements. A report was produced to document the process and the design products.

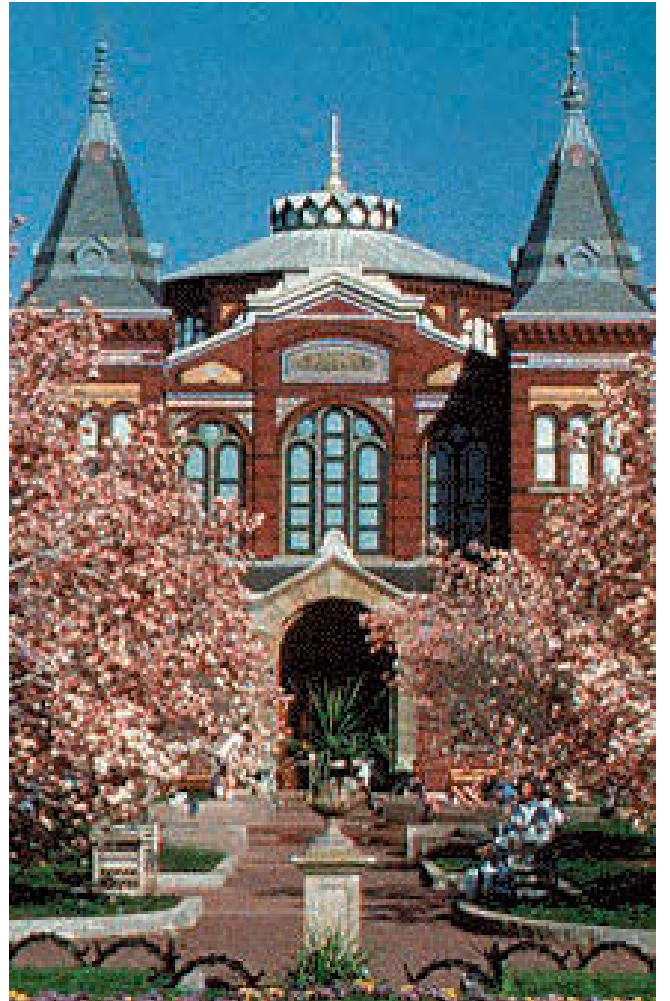

Smithsonian Institution Arts and Industries Building

Washington, DC



Size
168,500 gsf

Construction Cost
\$180 million

Completion Date
2001 (Design)

Restoration and adaptive-use for galleries, education classrooms and labs, and visitor services with the addition of a 40,000 sf underground service wing to include a loading area, new mechanical systems and administrative support spaces.

Built as the first building to house the National Museum, the structure is basically symmetrical in plan and elevation as it is organized in the form of a Greek Cross around a large central rotunda located at the intersection of the four major exhibit halls that divide the building into four equal quadrants. Each quadrant contains the remains of a court and two ranges, originally open to the halls and the roof, and functioned as exhibition space in conjunction

with the halls. SmithGroupJJR completed a design for the restoration of these courts, which had been filled-in with mechanical systems during the numerous renovations.

Each façade, oriented to a different cardinal compass point and reflecting the arrangement of the interior is composed of articulated brick pilasters and in-fill brick walls, corbelled eaves, 3-story pavilions at the corners, and 3-story towers located at the center of each façade flanking entrances to the four exhibit halls. Steep pyramidal roofs top the towers. The roof line is a prominent feature of the building reflecting the maze of angles and slopes of the various roof types covering the halls, courts, ranges and rotunda.

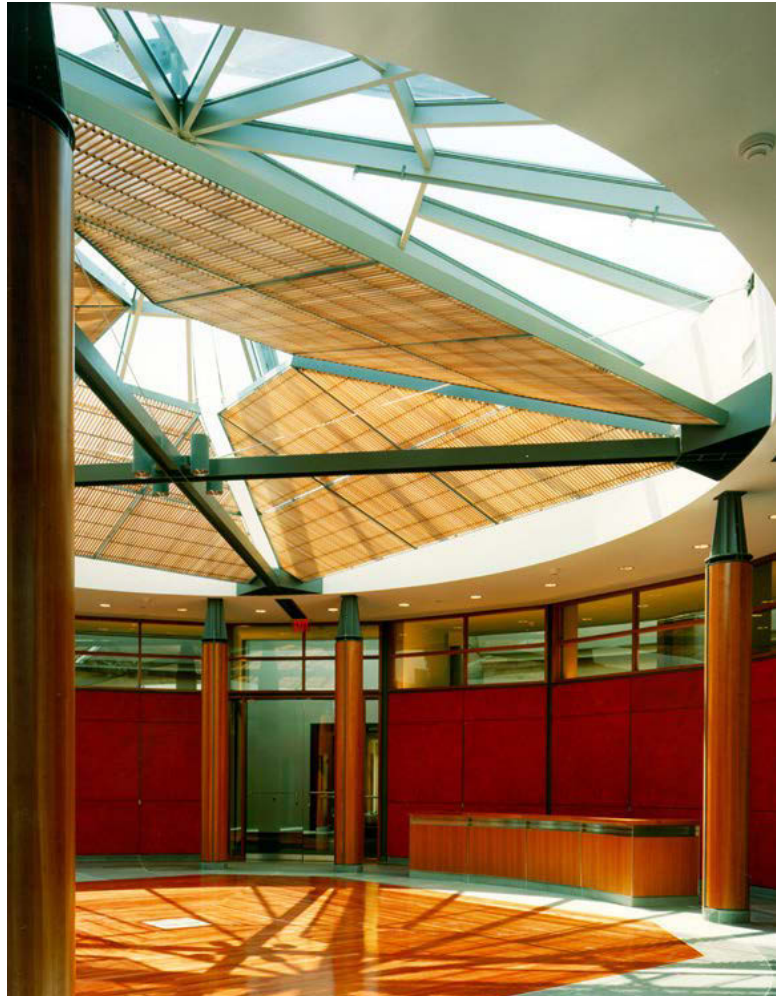

"This is a wonderfully detailed building. It has a great deal of clout. We appreciate the effort shown in how certain Native American ideology is used in the overall concept, in how the building is situated on its site, the procession shown in its form, and how one navigates through the building. Somebody had a lot of fun with this. The use of materials is very imaginative."

Jury Quote, AIA Northern Virginia Chapter, 2000 Design Awards

National Museum of the American Indian Cultural Resources Center

Suitland, Maryland

Size

200,000 gsf

Construction Cost

\$39 million

Completion Date

2001

Completion Date

- Award of Excellence in Architecture, Northern Virginia Chapter AIA, 2000
- Award of Excellence in Architecture, Virginia Society AIA, 2000
- Honor Award, New York Chapter AIA, 2000

This 200,000 gsf building serves both as a **museum conservation center** and cultural and religious center for Native Americans. In developing the design concept, Polshek/SmithGroupJJR and the Native American Design Collaborative, Hal Davis and the design team worked with Native Americans from throughout the Americas to distill a series of principles for design from diverse tribal traditions, beliefs and practices.

Drawing upon organic structural systems such as the pine cone, chambered nautilus, and spider web, the design reinforces the unity of the natural and built environments and incorporates the exterior landscape for ceremonial uses. Interior spaces emphasize an intimate and spiritual environment in keeping with Native American traditions.

The client wanted to collocate functions in order to make the divisions between as transparent as possible, therefore a relative humidity of 50% and a temperature variance of +/- 2 degrees was required throughout the entire building. This indoor environmental quality mandated careful consideration of the components of the building envelope.



All exterior surfaces are detailed with a continuous air/vapor barrier, insulation, and a series of vented cavities designed to diminish the amount of forced air and water pressure into the building. This pressure equalized rain screen protects the building for both summer and winter conditions. Wall systems include flat seam aluminum panels, precast concrete panels, flat seam and standing seam Terne coated stainless steel, and corrugated Aluminum panels. The window glazing system ties into the air/vapor barrier and combined with supplemental heat through the use of fin tube or forced air, condensation is reduced or eliminated. These components along with a highly efficient mechanical systems, contribute to the building's energy efficiency. A pre-action sprinkler system was utilized for fire protection.

The connection of the American Indian to the land is echoed in the sustainable design incorporated throughout this facility. SmithGroupJJR conducted extensive research into the **Volatile Organic Compound (VOC) content of every material** in the building. Mr. Davis led the effort for the design of the **archival and preservation spaces and storage system** as well as the technical design for the vapor barrier such that it was uninterrupted for the entire perimeter.

Subsequent work at the Cultural Resources Center has included providing digital interconnectivity from the building to the nearby Museum Support Center and diagnostic work to determine issues created during construction.



"I cannot emphasize enough how respectful the design team was of what Eiel Saarinen created. The goal of the project was to make sure the space was as beautiful as it was in 1942, yet meeting all of the needs of a 21st century museum. The designers were able to accomplish this goal in a way that was virtually invisible to all of our visitors. Additionally, the Museum's new Collections Wing is reinventing our relationship with the general public. It's the sequencing of the experience; the sense of wonder, of excitement, the wow factor has truly been institutionalized in this building."

Reed Kroloff, Director of Cranbrook Academy of Art and Art Museum and Greg Wittkopp, Director of Cranbrook Art Museum



Cranbrook Art Museum & Library

Climate Control & Collections Protection

Bloomfield Hills, Michigan

Size

30,000 gsf addition/52,000 gsf existing

Construction Cost

Confidential

Completion Date

2011

Completion Date

- 39th Annual Interior Design Award (International), International Interior Design Association (IIDA), 2012
- Illumination Award of Merit, Illuminating Engineering Society of North America (IESNA), 2012
- Illumination Award, Illuminating Engineering Society of North America (IESNA) — Detroit Chapter, 2012
- Honor Award, Masonry Institute of Michigan (MIM), 2012
- Light & Architecture Design Award (International), Architectural Lighting, 2012
- Brick in Architecture — Gold Award, Commercial, Brick Industry Association, 2012

The Cranbrook Capital Projects Office commissioned SmithGroupJJR to implement improvements to the conservation environment for the Cranbrook Museum and Library, to determine corrections necessary to care for the historic building and provide a new addition to house current and future museum collections. The evaluation and conditions assessment of these facilities determined the need for the following general corrections and repairs necessary to the basic care of the buildings:

- Roof replacement and provision of new flashings and trim.
- Exterior wall brick and stone masonry mortar joint repointing and cleaning.
- Repair of miscellaneous cracked and displaced stone and brick.
- Corrections to the historic exterior walls to provide improved thermal and vapor performance.
- Window period replacements of certain historic window systems and protection of historic leaded glass windows from an improved conservation environment.
- Disassembly and rebuilding of the Chinese Dog Stair and Paristyle Stair and Plaza with new waterproofing and repairs to the existing structure.
- Provision of snow melting systems for the Chinese Dog Stair and Paristyle Stair and Plaza.
- Repairs to the loading dock, miscellaneous doors, and exterior soffits. New collections storage addition.
- Full replacement of the existing HVAC systems and provision of a full conservation environment throughout the Museum and Library.

Cranbrook identified a need for improved museum climate control, additional art storage and museum exhibit space additions to the existing 52,000 gsf Museum facility. The historic museum also needed interior space enhancements and preservation, electrical and exhibit lighting system upgrades, and numerous building repairs. To support Cranbrook's needs for the historic Eliel Saarinen designed Art Museum and Library, SmithGroupJJR was retained to provide building enclosure and HVAC system evaluations and renovation concepts. SmithGroupJJR developed multiple concepts for the provision of acceptable conservation environments and alternative corrections to the historic wall, window, and entry systems.

The resulting addition and renovation project includes full replacement of the mechanical and electrical systems, full replacement of the existing lighting systems with new exhibit lighting integrated with portions of the historic Saarinen lighting design and historic fixtures, substantial fire protection system upgrades, and numerous wall, roof, and window corrections and modifications to withstand the new conservation environment. It also includes an approximate 30,000 gsf art storage addition which includes a seminar/research room. Design maintained a primary focus on both satisfying the critical Museum planning issues and the historic preservation of this facility. Considerable on-site investigation of the building envelope and advanced engineering analysis and planning for the building and HVAC systems was necessary to achieve this goal.

SmithGroupJJR provided full architectural and engineering design services.

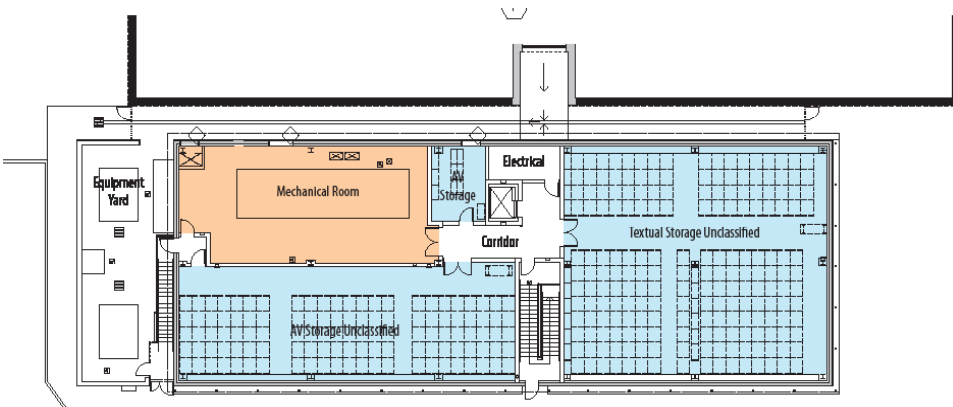

First Floor



Site Plan

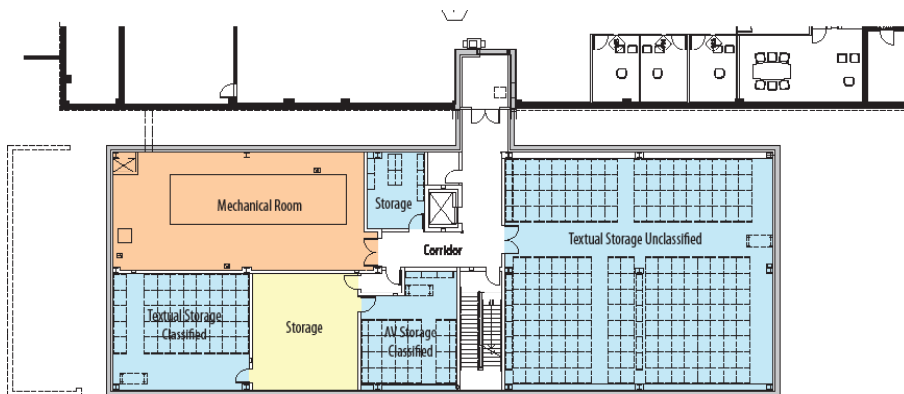

Second Floor

National Archives and Records Administration Richard Nixon Presidential Library & Museum

Yorba Linda, California

Size

14,478 gsf

Construction Cost

\$5 million

Completion Date

2010

As part of an Indefinite Quantity Indefinite Delivery Contract to provide design and related services for **NARA facilities nationwide** that supports all existing and future National Archives and Records Administration (NARA) facilities including **Presidential Libraries, Regional Archives, National Records Centers, the National Archives Building, Archives II and Affiliate Archives**, SmithGroupJJR led by Hal Davis designed the **14,478 gsf new wing for the existing Richard Nixon Presidential Library and Museum**. The new wing houses approximately 40,000 cubic feet of archives and processing areas for **classified and recently declassified documents** from Nixon's Presidential Administration. The project scope of work also included **HVAC upgrades** for the existing Museum exhibit areas to meet **NARA standards**. The design prioritized the technical requirements for archival storage, blending with the neighborhood and museum context, and appropriate grandeur for the project location.

The new wing is designed meet stringent **NARA Standards for Archives and NARA Standards for Presidential Libraries**. The new wing is also in close proximity to the National Historic Landmarked Richard Nixon Birthplace, so the design included an **Environmental Assessment (EA)** to comply with Section 106 of the National Historic Preservation Act. A portion of the new wing was designed for classified archives and processing and meets **Director of Central Intelligence Directive 6/9 security requirements for a Sensitive Compartmented Information Facility**. SmithGroupJJR's implementation of NARA standards emphasized redundant waterproofing and redundant HVAC to protect the collection while minimizing cost and maximizing longevity. The HVAC design uses high-efficiency equipment and a highly insulated thermal envelope to maximize energy efficiency and minimize operating costs. Pre-action sprinklers were used for fire protection. The new wing's **structural design exceeded California seismic requirements to meet NARA building design-life requirements**. Additionally, the design documents included detailed contractor staging plans, demolition plans, and temporary infrastructure plans to minimize any impact to the existing museum's continuous operation and special cultural events.

The proportions, sectional characteristics and massing of the new addition blend with the existing museum and surrounding historical downtown neighborhood of the City of Yorba Linda. The contextual blending of new wing design is enhanced by sensitively matching the new addition to the style of the existing museum by using the same materials. The new addition is clad in matching local sandstone and a terracotta tile roof. The cladding materials are upgraded from typical for a stand alone building of this type, but necessary due to the prominent location adjacent to the Museum main entrance and visible from a main street in the City of Yorba Linda. The upgraded cladding was judiciously utilized to balance cost and aesthetics; less costly exterior plaster cladding was selected for portions of the façade not publicly visible. The resulting design was within budget and respects the Richard Nixon Birthplace and the Richard Nixon Burial Site.

Subsequently, this addition has allowed the Richard Nixon Presidential Library and museum to expand its research holdings, and elevate its profile as a research and cultural institute. After completion of the new wing and HVAC upgrades, the Richard Nixon Presidential Library and Museum has been able to add new museum exhibits and host numerous national media events for presidential elections and other political dignitaries.



Exhibit Space



Theater

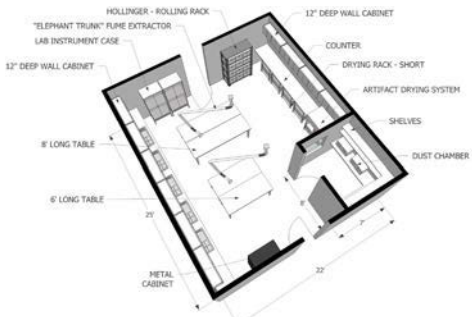

Artifact Processing Lab



St. Mary's College Anne Arundel Hall and Maryland Heritage Interpretive Center

St. Mary's City, Maryland

* 100% Construction Documents completed. The project is on hold pending funding from the State of Maryland.

Size

49,149 gsf

Construction Cost

\$10.8 million

Completion Date

2015

SmithGroupJJR designed a new academic building and visitor center, a joint project for St. Mary's College and for Historic St. Mary's City. The facilities include an interpretative center, archaeology and anthropology research and conservation labs, offices, classrooms and meeting rooms on the site of the fourth permanent settlement in British North America, founded in 1634. The project site is extremely complex; archaeological remains are prevalent and the precinct is an important point of connection between the College's historic academic core campus and its new north campus which now contains an equal distribution of academic functions. An easement through an adjacent property provides a route for pedestrian circulation, a utilities tunnel extension, and service access. The site is bounded by a busy state road and options for creating a pedestrian bridge versus a variety of traffic calming measures were evaluated.

SmithGroupJJR was also responsible for engineering design through the Design Development phase. Water source heat pumps are applied as part of a vertical ground-coupled geothermal heat pump system and serve both buildings. Dedicated split systems serve 24/7 artifact storage spaces. Outside air energy recovery units pre-condition air to units with greater than 30% outside air. Water conservation measures include low-flow fixtures and a rainwater collection/non-potable water system that supplies toilets and urinals in both buildings. Self-contained de-ionized water systems serve artifact processing spaces. New medium and low voltage and telecommunications duct banks are provided to serve the new buildings. Emergency power for Anne Arundel Hall is provided by an outdoor, diesel stand-by emergency generator; whereas, emergency power for the Maryland Heritage Interpretive Center is provided by a central battery inverter. High efficiency, direct/indirect lighting, occupancy sensors and daylight dimming comprise the lighting strategies employed to conserve energy. Pre-action sprinkler systems are provided for artifact collections storage spaces. Systems are designed to support phased construction of buildings, and are projected to use 70% less energy than a conventional building through incorporation of passive solar design, ground-source heat pumps, and an efficient envelope and HVAC system.

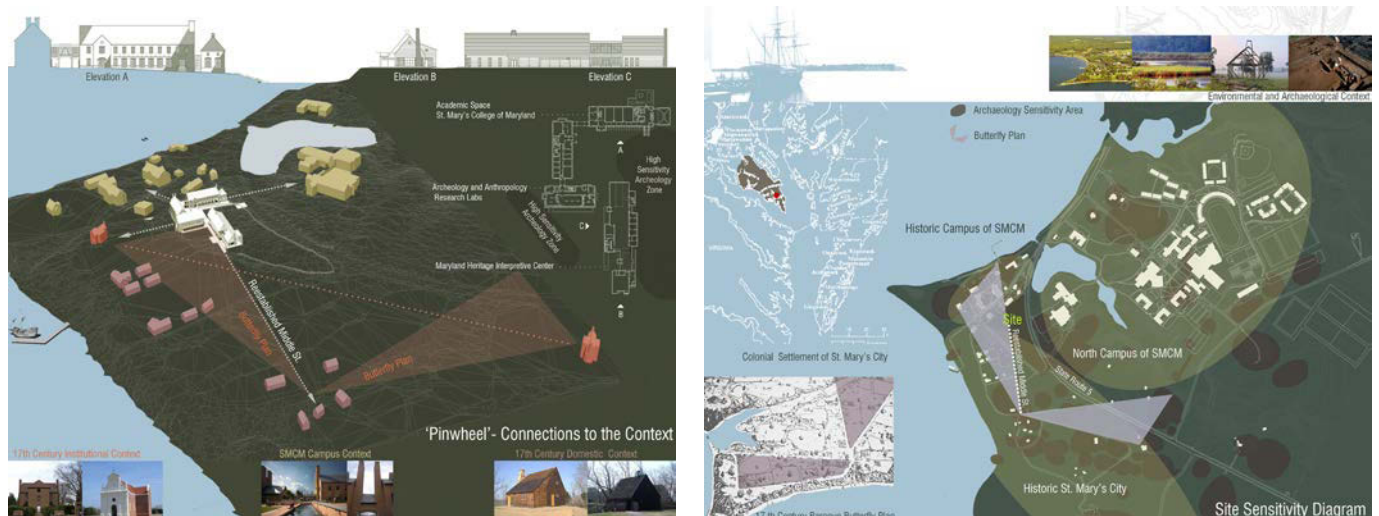

Project Leadership





Kevin Shultis, AIA, LEED AP

Cultural Practice Leader

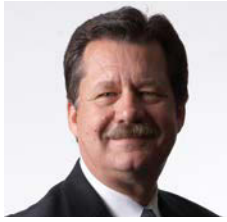

Kevin Shultis is the Cultural Studio leader for SmithGroupJJR's Detroit office. He has over 30 years of design and management experience in the architectural profession which has earned a reputation for outstanding work in cultural facilities. His background includes successful

leadership in projects in the cultural and learning market sectors. He brings a unique understanding of and perspective to art-centric facility design and is especially skilled in the integration of learning environments.

As principal of the cultural practice, Kevin has led his team in the management of many intricate master plans and cultural projects including Muskegon Museum of Art, Indian Springs Metropark James Clarkson Environmental Discovery Center, the National Hurricane Museum and Science Center, Cranbrook Art Museum and Library Climate Control and Collections Protection, the Detroit Athletic Club Master Plan, the West Virginia University Art Museum and Rare Book Room, the Flint Cultural Center Corporation Sloan Longway Museum Master Plan and the Western Michigan University School of Art, Richmond Center for Visual Arts.

Kevin has a Bachelor of Science degree and a Master of Science degree in Architecture from the University of Michigan.

Hal Davis, FAIA

Cultural Practice Leader



Hal Davis is a Senior Vice President at SmithGroupJJR and performs comprehensive management and design responsibilities. Both a Registered Architect and a Registered Interior Designer, he has more than 40 years of experience with complex cultural projects.

Hal has provided team leadership on several of the firm's larger cultural projects including the Library of Congress National Audio Visual Conservation Center, Smithsonian Institution National Museum of the American Indian and the American Indian Cultural Resources Center, Smithsonian Institution National Museum of Natural History Museum Support Center, National Museum of African American History and Culture, National Archives and Records Administration IDIQ and the Smithsonian Institution Arts and Industries Building.

Beyond commitment and contributions to clients, colleagues, project teams, and the firm, he has contributed advancement to the profession through innovation with examples such as: co-developing an equivalency to NFPA 40 for the safe storage of nitrate film for the National Audio Visual Conservation Center for the Library of Congress and for the UCLA Film Archive in California; leading the development of prototypical archival storage and enclosure systems

Hal has a Master of Architecture from the University of Pennsylvania and a Bachelor of Architecture from Clemson University. He is an active member of the American Association of Museums, Mid-Atlantic Association of Museums and the Washington Architectural Foundation.

Paul Urbanek, FAIA, LEED AP
Principal Designer



Paul Urbanek is Vice President of Design for the Detroit office of SmithGroupJJR. He has over 30 years of experience in architectural design for a wide range of projects including cultural and learning. His creative problem solving process has provided fresh viewpoints and

new concepts for functional and aesthetically exciting design solutions.

Paul has provided design leadership for award-winning cultural projects including the Indian Springs Metropark James Clarkson Environmental Discovery Center. In addition, as design leader, Paul has led his design team on the following cultural practice projects, the National Hurricane Museum and Science Center, Cranbrook Art Museum and Library Climate Control and Collections Protection, the West Virginia University Art Museum and Rare Book Room, the Flint Cultural Center Corporation Sloan Longway Museum Master Plan, the Western Michigan University School of Art, Richmond Center for Visual Arts and the Ford Center for Environmental & Conservation Education at the Detroit Zoo.

Paul has a Bachelor and Bachelor of Science degree in Architecture from Lawrence Technological University.

Curt Songer, PE, LEED AP
Archival and Collections Care Expert



Curt Songer previously served as Director of Mechanical Engineering for SmithGroupJJR and is presently Vice President and Director of Mechanical Special Services. With 39 years of mechanical design experience, he is highly experienced in providing for the specialized

needs of museum environments and has extensive knowledge in conservation science including system designs for humidity and temperature control, high accuracy special exhibits space design, specialized environments for collection archival spaces, and specialized building envelope design for conservation environments. Curt pioneered our development of building enclosure design and analysis for high humidity and unique environment exposures, authored SmithGroupJJR's in-house building enclosure hydro-thermal analysis software, and has led our application of specialized analysis software for detailed wall, roof, and window system design.

He has provided archival and collections care for many cultural institution projects including the Smithsonian Institute Arts & Industries Building, Cranbrook Art Museum and Library Climate Control and Collections Protection, Newark Museum, Detroit Institute of Arts, Florida Museum of Natural History, National Postal Museum, National Hurricane Museum and Science Center, National Archives and Records Administration Nixon Library and Archive, Library of Congress National Audio Visual Conservation Center, Museum of the Bible and the Virginia State Library and Archives

Curt holds a Bachelor of Architecture in Engineering from Penn State University. He has been a featured speaker several times at the American Association of Museums National Convention, as well as a speaker for the National Institute of Standards and Technology.

Brian Noonan, PE, LEED AP, NCEES Mechanical Engineer



Brian Noonan is a Principal at SmithGroupJJR with sixteen years of mechanical engineering experience. Brian has special knowledge of critical environment temperature and humidity control with an emphasis in museum mechanical systems. His experience within this

area of expertise includes integration of mechanical systems into existing building with sensitivity to the historic significance of the building as well as providing innovative solutions to complex space layouts and conditioning requirements.

Brian has proven experience applying sound engineering principles, which provide reliable and cost effective solutions to all aspects of thermal comfort, health, and energy efficiency associated with building mechanical systems. His role at SmithGroupJJR includes lead and support responsibilities across the full spectrum of mechanical engineering related to the built environment in addition to plumbing systems and fire protection engineering and design. He is also involved in the assessment of existing systems, construction administration and commissioning.

Several cultural projects for which Brian has provided mechanical engineering services include Cranbrook Art Museum Renovation, Library Climate Control and Collections Building, Detroit Institute of Arts Master Plan Implementation and Expansion, Flint Cultural Center Sloan Longway Museum Master Plan, National Hurricane Museum and Science Center, and the U.S. Holocaust Memorial Museum Collections and Conservation Center.

Kevin holds a Bachelor of Science degree in Architectural Engineering from Kansas State University.

Rodrigo Manríquez, IALD, LC, IESNA Lighting Studio Leader



A Principal with SmithGroupJJR, Rodrigo Manríquez has over eighteen years of experience providing lighting design expertise and leadership across a wide range of projects.

Rodrigo conceptualizes lighting solutions as an integral component of the design process by understanding the critical role that lighting design plays in the way architecture evokes emotions. He strives to raise awareness about the integration of lighting design to clarify the manner in which we perceive architectural environments. His approach to lighting design is to creatively address hierarchy, transition, direction, order, and perception. Rodrigo believes that lighting defines the architectural envelope by establishing a visual hierarchy of elements while almost subliminally affecting the public's perception of space.

Highlights from Rodrigo's extensive project list include Museum of the Bible, National Museum of American History Star Spangled Banner Lab, Detroit Institute of Arts Exterior Lighting Master Plan, and The Ford Center for Environmental and Conservation at the Detroit Zoo.

Rodrigo has a Bachelor of Science in Architectural Engineering - Lighting Design from the University of Kansas, and is an active member of the Illuminating Engineering Society of North America and the International Association of Lighting Designers.

ANN ARBOR

CHICAGO

DALLAS

DETROIT

LOS ANGELES

MADISON

PHOENIX

SAN FRANCISCO

SHANGHAI

WASHINGTON, DC

SMITHGROUP JJR

www.smithgroupjjr.com

**Walter P. Reuther Library, Archives of Labor and Urban Affairs
Application to the National Endowment of the Humanities
Sustaining Cultural Heritage Collections: Planning Grant**

Conservation and Environmental Condition Assessment

Appendix 7C: Photographs of the Reuther Library



Google Earth Photograph
<https://www.google.com/maps/@42.3588533,-83.0663718,235a,20y,270h,41.65t/data=!3m1!1e3>
Accessed November 1, 2015



East and North Facades



South and East Facades



South Façade

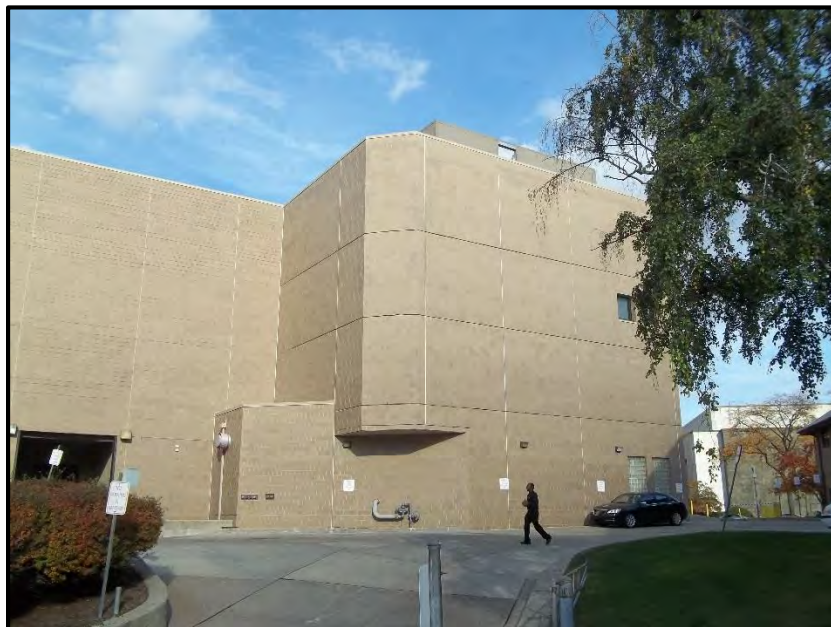

Southwest façade



West Façade



Northwest Façade

**Walter P. Reuther Library, Archives of Labor and Urban Affairs
Application to the National Endowment of the Humanities
Sustaining Cultural Heritage Collections: Planning Grant**

Conservation and Environmental Condition Assessment

Photographs of Endangered Collections

Continuing challenges with environmental storage conditions at the Reuther Library poses serious threat to the long-term preservation of the entire collection. Some manuscript materials, however, are at higher risk for deterioration or loss. Three examples illustrate the challenges affecting these holdings.

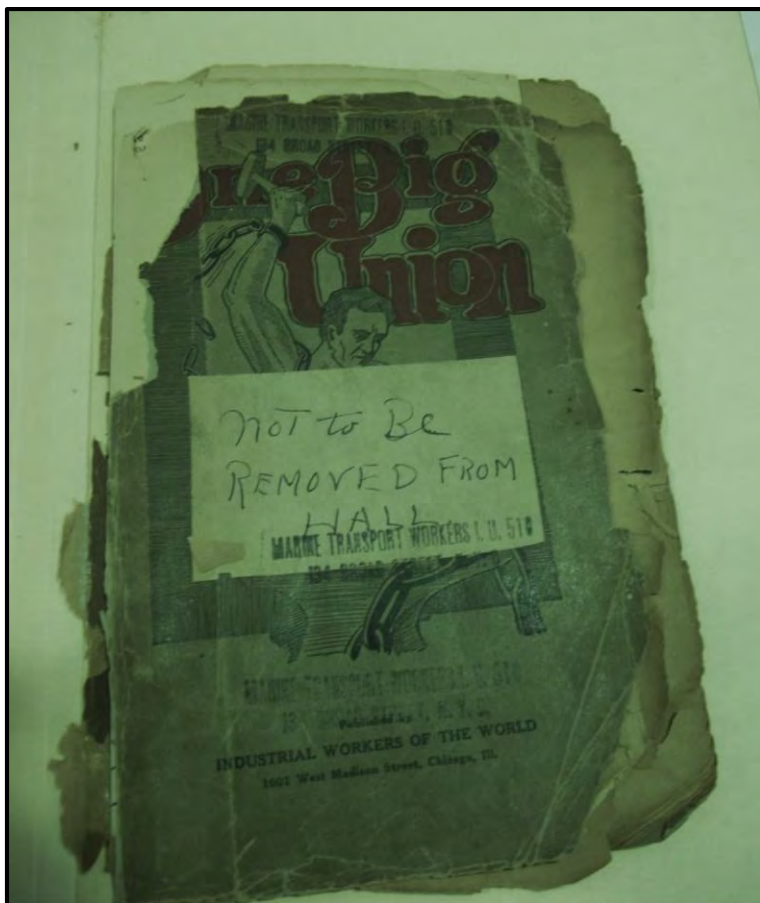

One of the flagship collections housed at the Walter P. Reuther Library is that of the **Industrial Workers of the World**. This labor organization, also known as the “Wobblies,” agitated for “One Big Union” across all industrial sectors and across the entire nation. The collection contains numerous pamphlets and publications with preservation challenges. Although degradation occurred through misuse and handling prior to addition to the Reuther Library, storage and environment present serious additional concern for these items of permanent retention.



The Merrill-Palmer Skillman Institute was one of the forerunners of the discipline of early childhood development, domestic education for parents, and training for medical practitioners in urban and poverty settings. It is considered to have played a key role in national standards such as the Head Start Program. The Reuther Library is home to these important papers, which include mixed document and audiovisual material susceptible to unstable temperature and humidity conditions.



In 1878 the **Associated Charities of Detroit** was created to better serve the city's impoverished residents. Caseworkers interviewed those seeking assistance and referred them to the departments or charities that could best fulfill their needs. Associated Charities also would occasionally provide clients with immediate temporary assistance, such as overnight lodging, meal tickets, or clothing. Each case was detailed in a set of ledgers, now part of the collection at the Reuther Library, which document the difficult lives of Detroit's poverty-stricken and the social network created to help them in the late 19th century.

**Walter P. Reuther Library, Archives of Labor and Urban Affairs
Application to the National Endowment of the Humanities
Sustaining Cultural Heritage Collections: Planning Grant**

Conservation and Environmental Condition Assessment

Appendix 7E: Floor Plans

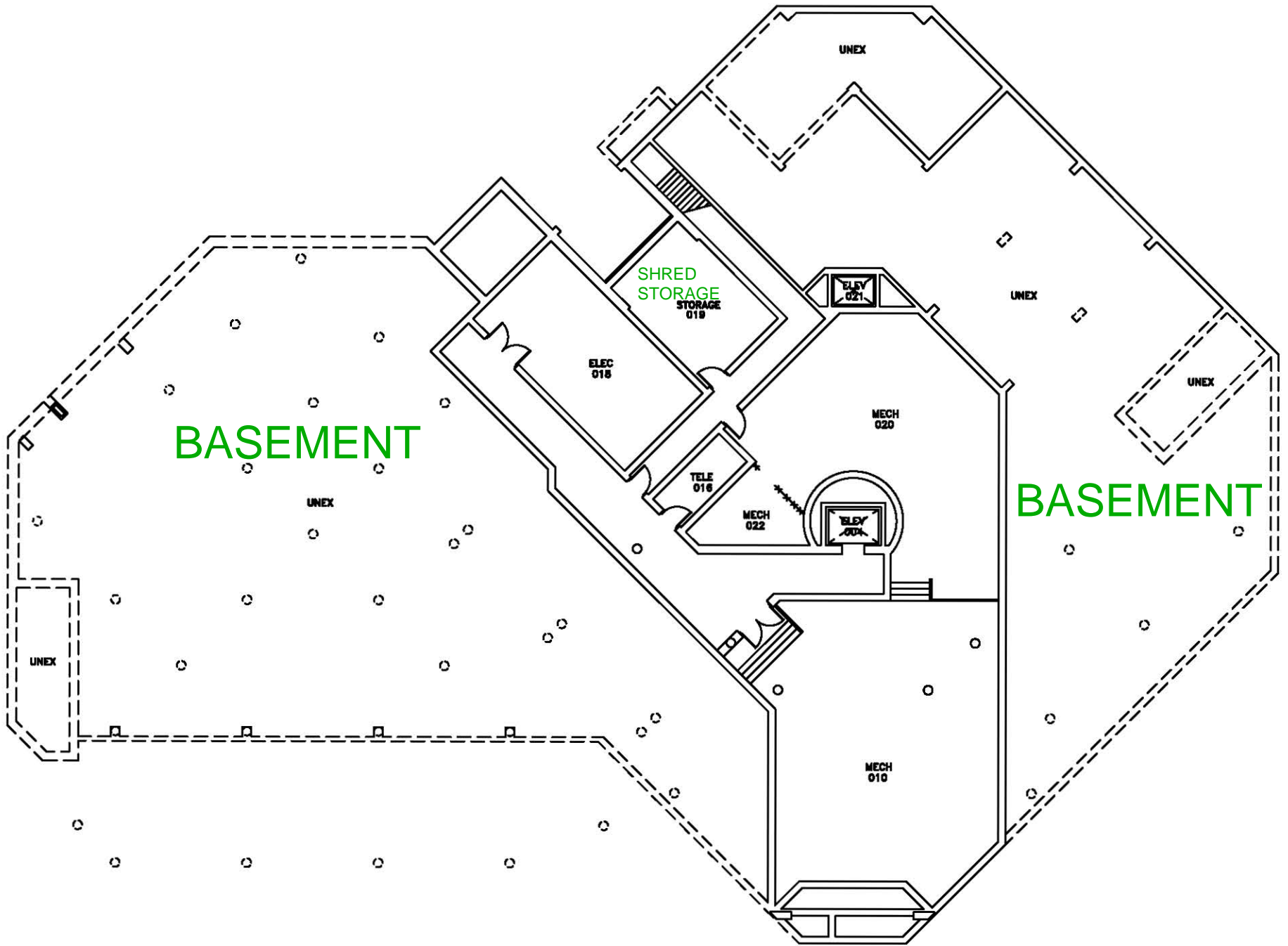

014

WALTER P. REUTHER LIBRARY
 BUILDING #036
 BASEMENT FLOOR PLAN

Wayne State University - Planning Grant Application - Page 17



DISCLAIMER:
 WAYNE STATE UNIVERSITY, FACILITIES PLANNING AND MANAGEMENT
 MAKES THESE DOCUMENTS AVAILABLE ON AN "AS IS" BASIS.
 THESE DRAWINGS WERE CREATED USING AUTOCAD FROM AUTODESK AND
 ARE ACCURATE FOR SPACE MANAGEMENT, "FLOOR PLAN" USE. THE
 USERS WILL HOLD HARMLESS WSU, ITS OFFICERS, AGENTS, AND
 EMPLOYEES FROM DAMAGES OR COST, INCLUDING REASONABLE
 ATTORNEY'S FEES, ARISING FROM THE USE OF THESE DRAWINGS.

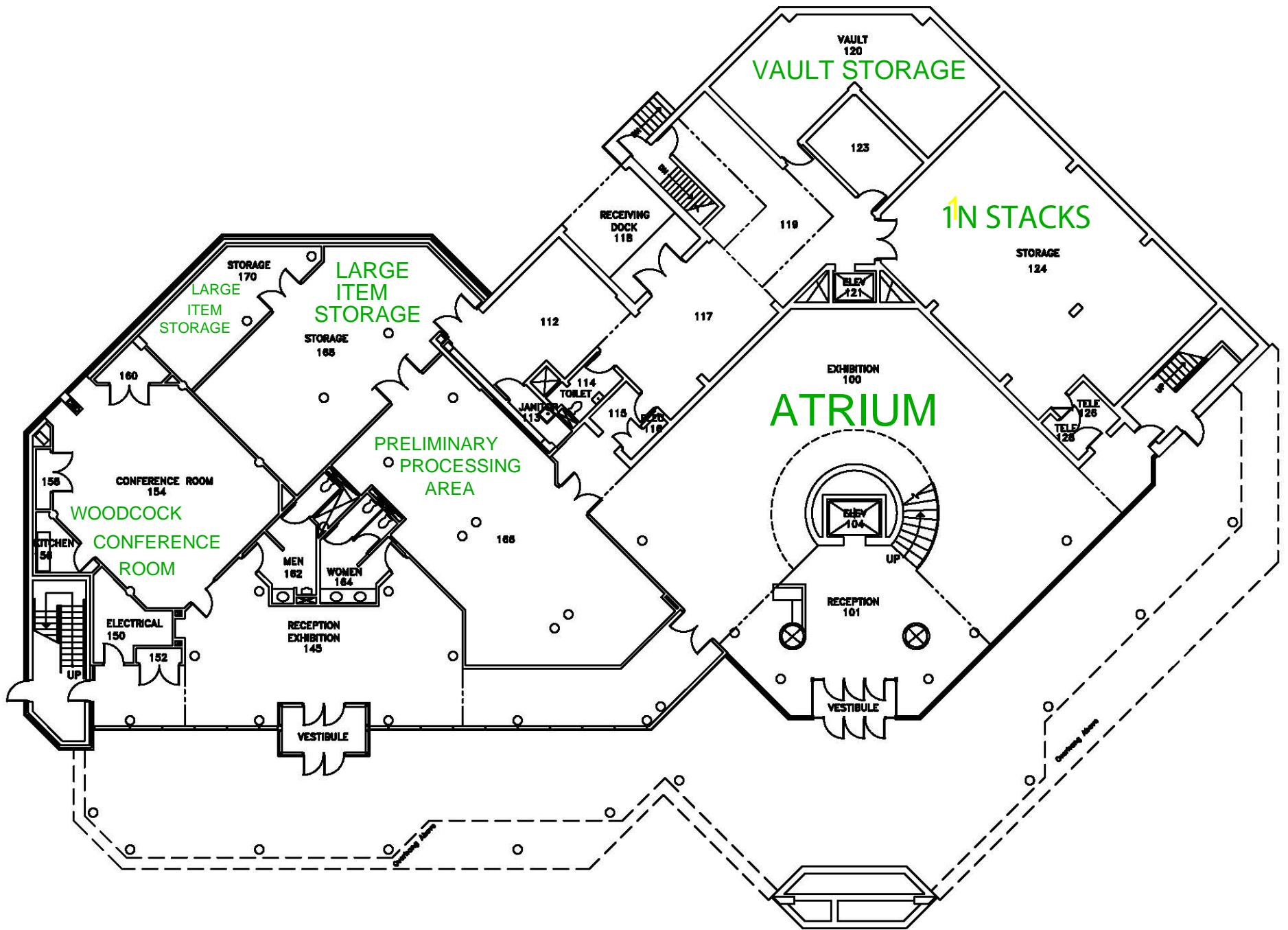

015

WALTER P. REUTHER LIBRARY
 BUILDING #036
 FIRST FLOOR PLAN

Wayne State University - Planning Grant Application - Part 2



DISCLAIMER:
 WAYNE STATE UNIVERSITY, FACILITIES PLANNING AND MANAGEMENT
 MAKES THESE DOCUMENTS AVAILABLE ON AN "AS IS" BASIS.
 THESE DRAWINGS WERE CREATED USING AUTOCAD FROM AUTODESK AND
 ARE ACCURATE FOR SPACE MANAGEMENT, "FLOOR PLAN" USE. THE
 USERS WILL HOLD HARMLESS WSU, ITS OFFICERS, AGENTS, AND
 EMPLOYEES FROM DAMAGES OR COST, INCLUDING REASONABLE
 ATTORNEY'S FEES, ARISING FROM THE USE OF THESE DRAWINGS.

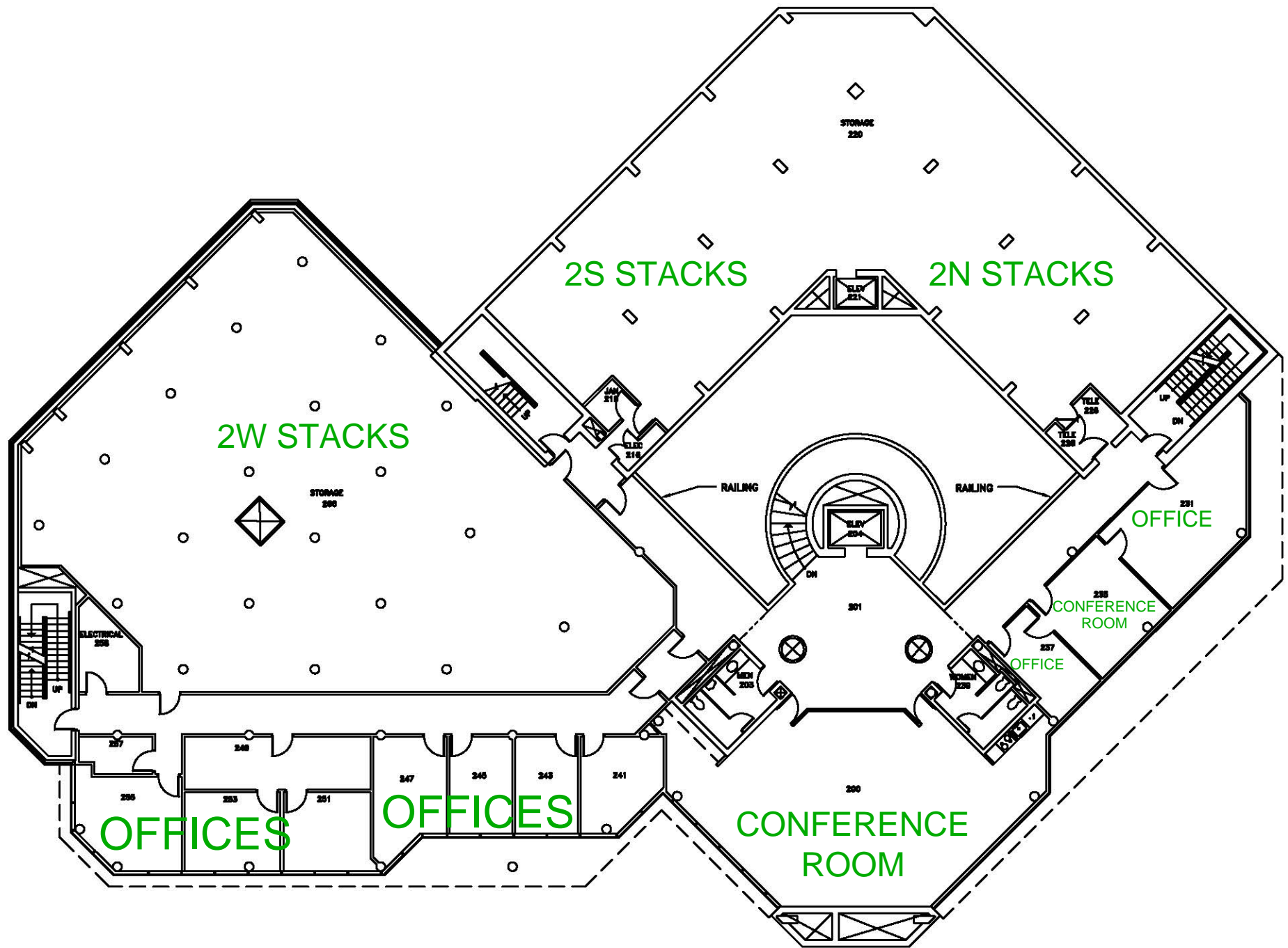

WALTER P. REUTHER LIBRARY
 BUILDING #036
 SECOND FLOOR PLAN



DISCLAIMER:
 WAYNE STATE UNIVERSITY, FACILITIES PLANNING AND MANAGEMENT
 MAKES THESE DOCUMENTS AVAILABLE ON AN "AS IS" BASIS.
 THESE DRAWINGS WERE CREATED USING AUTOCAD FROM AUTODESK AND
 ARE ACCURATE FOR SPACE MANAGEMENT, "FLOOR PLAN" USE. THE
 USERS WILL HOLD HARMLESS WSU, ITS OFFICERS, AGENTS, AND
 EMPLOYEES FROM DAMAGES OR COST, INCLUDING REASONABLE
 ATTORNEY'S FEES, ARISING FROM THE USE OF THESE DRAWINGS.

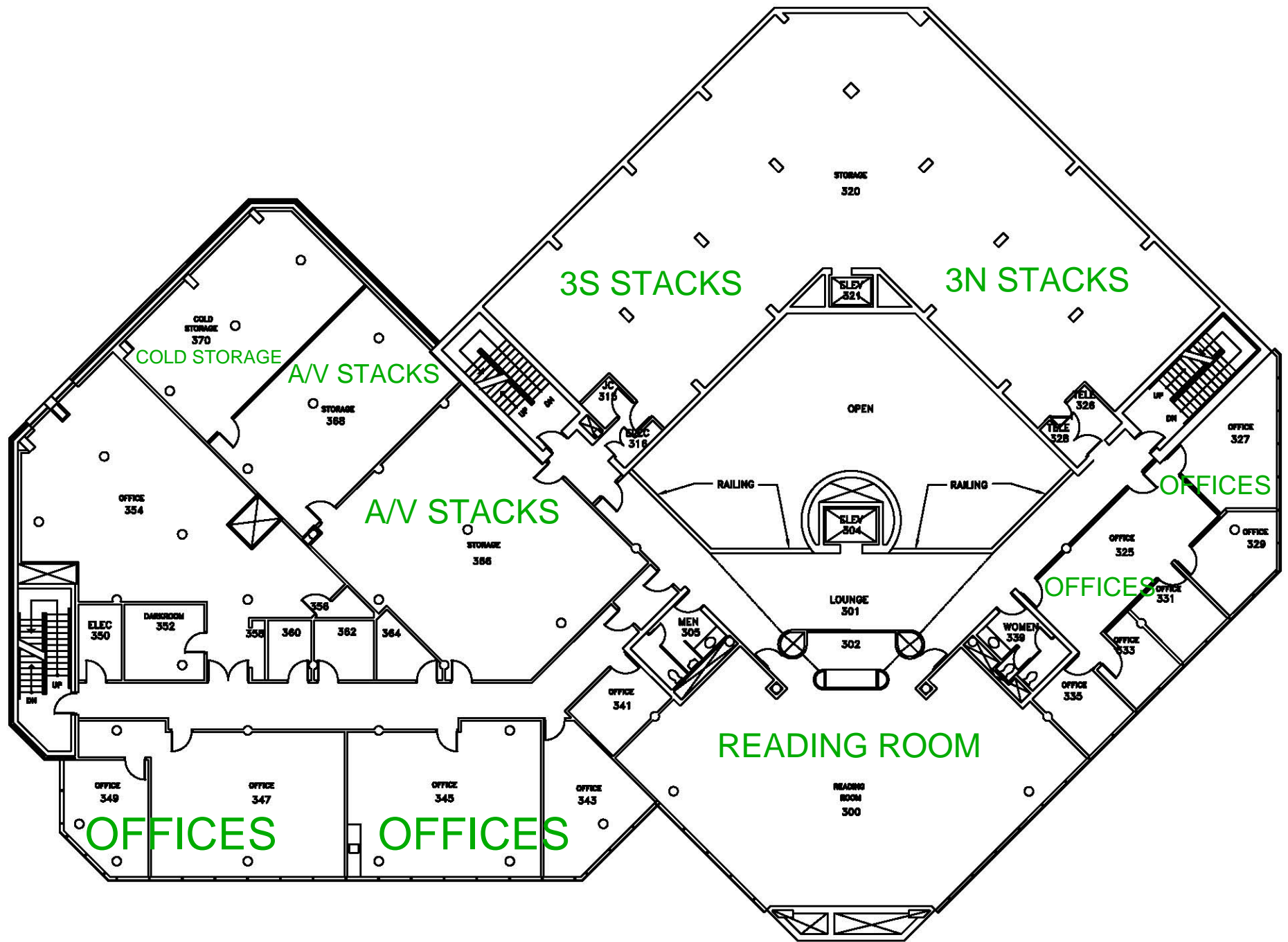

017

WALTER P. REUTHER LIBRARY
 BUILDING #036
 THIRD FLOOR PLAN



DISCLAIMER:
 WAYNE STATE UNIVERSITY, FACILITIES PLANNING AND MANAGEMENT
 MAKES THESE DOCUMENTS AVAILABLE ON AN "AS IS" BASIS.
 THESE DRAWINGS WERE CREATED USING AUTOCAD FROM AUTODESK AND
 ARE ACCURATE FOR SPACE MANAGEMENT. 'FLOOR PLAN' USE. THE
 USERS WILL HOLD HARMLESS WSU, ITS OFFICERS, AGENTS, AND
 EMPLOYEES FROM DAMAGES OR COST, INCLUDING REASONABLE
 ATTORNEY'S FEES, ARISING FROM THE USE OF THESE DRAWINGS.

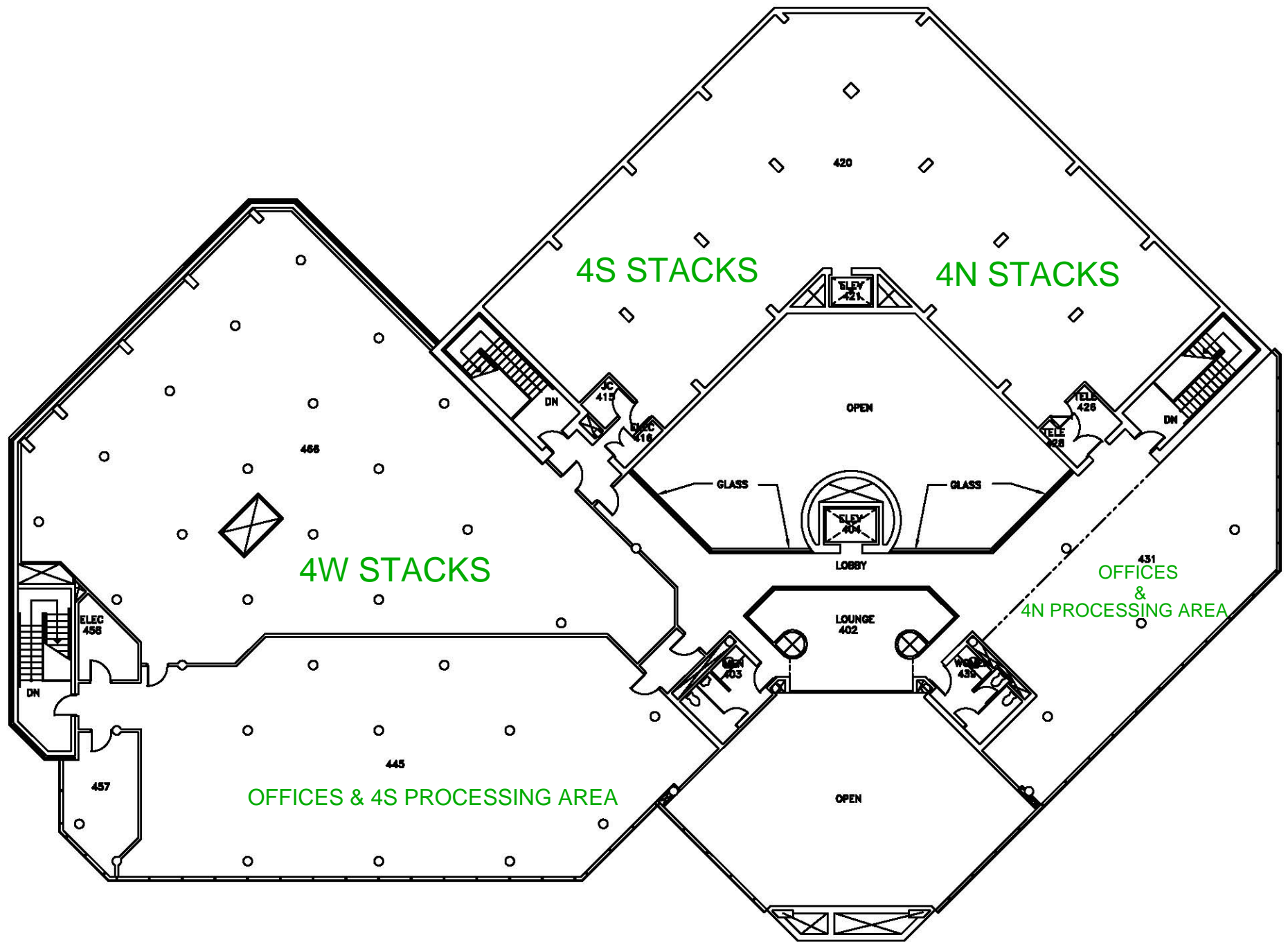

WALTER P. REUTHER LIBRARY
 BUILDING #036
 FOURTH FLOOR PLAN



DISCLAIMER:
 WAYNE STATE UNIVERSITY, FACILITIES PLANNING AND MANAGEMENT
 MAKES THESE DOCUMENTS AVAILABLE ON AN "AS IS" BASIS.
 THESE DRAWINGS WERE CREATED USING AUTOCAD FROM AUTODESK AND
 ARE ACCURATE FOR SPACE MANAGEMENT, 'FLOOR PLAN' USE. THE
 USERS WILL HOLD HARMLESS WSU, ITS OFFICERS, AGENTS, AND
 EMPLOYEES FROM DAMAGES OR COST, INCLUDING REASONABLE
 ATTORNEY'S FEES, ARISING FROM THE USE OF THESE DRAWINGS.

Appendix7-F: Selected Collection Storage Area Climate Data

Room 124: 1 North Stacks

August 2014-July 2015

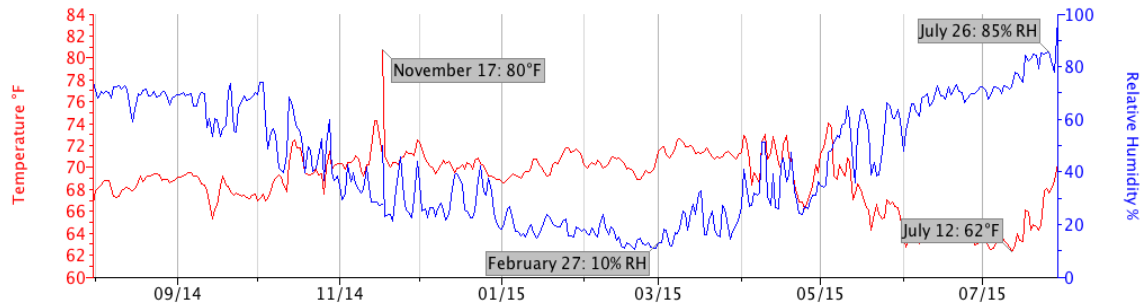

Yearly fluctuation: 62-80°F and 10-85% relative humidity

May 2015

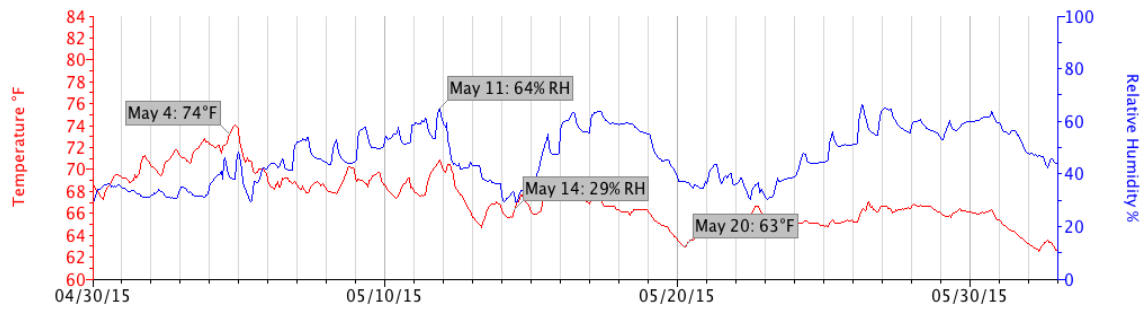

Monthly fluctuation: 63-74°F and 29-64% relative humidity

May 15, 2015

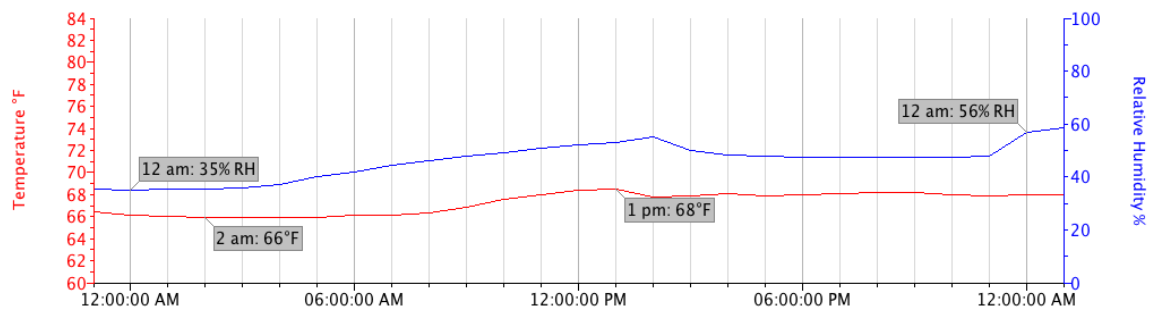

Daily fluctuation: 66-68°F and 35-56% relative humidity

Room 266: 2 Woodcock Stacks

August 2014-July 2015

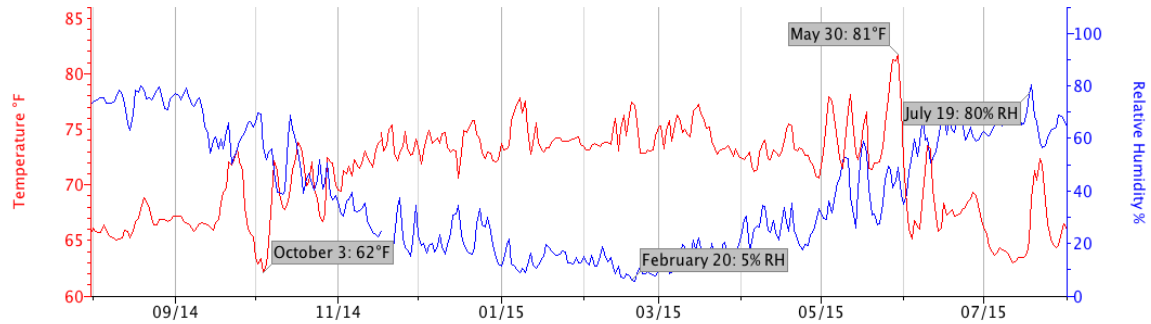

Yearly fluctuation: 62-81°F and 5-80% relative humidity

May 2015

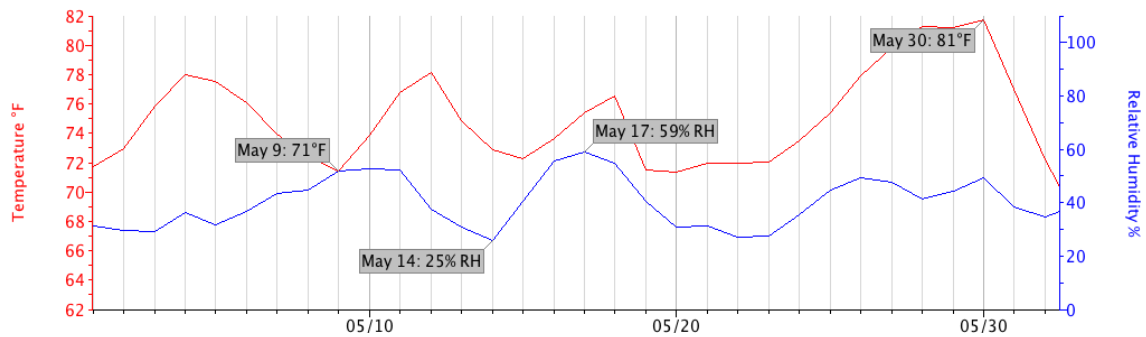

Monthly fluctuation: 71-81°F and 25-59% relative humidity

May 15, 2015

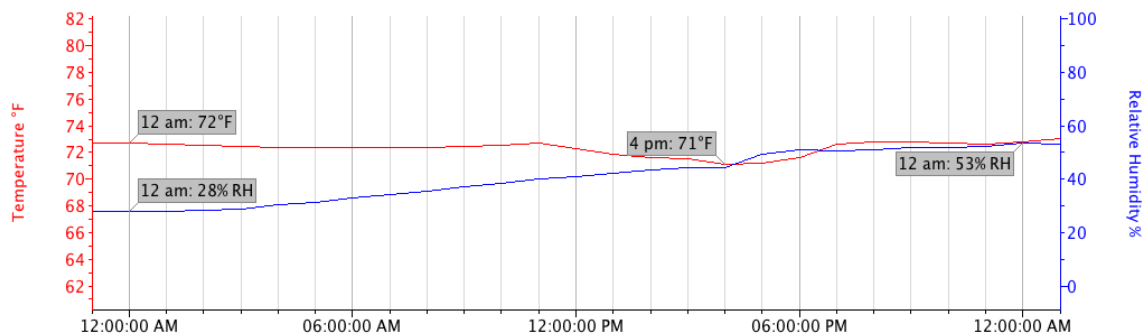

Daily fluctuation: 71-72°F and 28-53% relative humidity

Room 420: 4 North/South Stacks

August 2014-July 2015

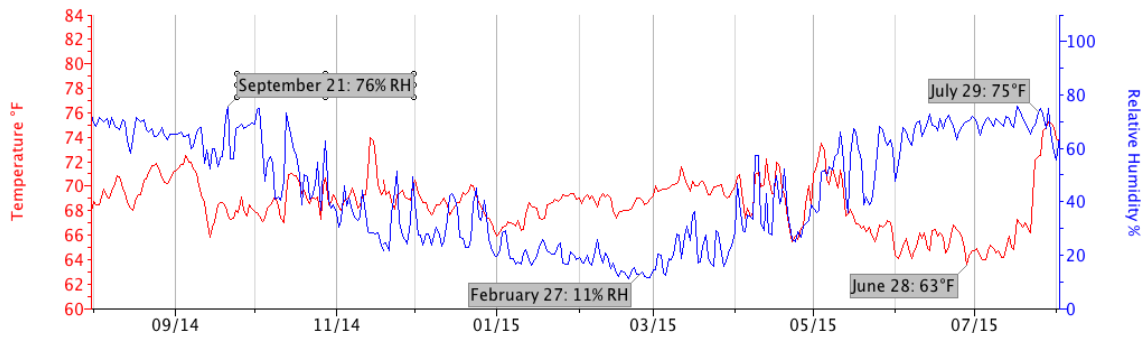

Yearly fluctuation: 63-75°F and 11-76% relative humidity

May 2015

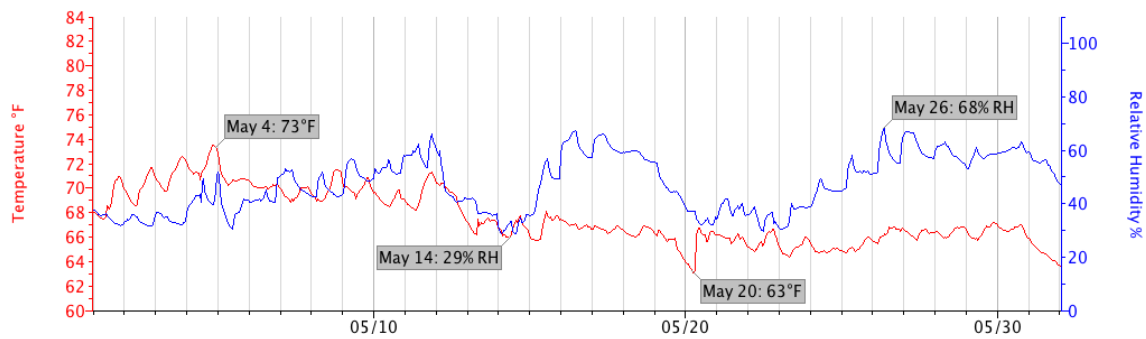

Monthly fluctuation: 63-73°F and 29-68% relative humidity

May 15, 2015

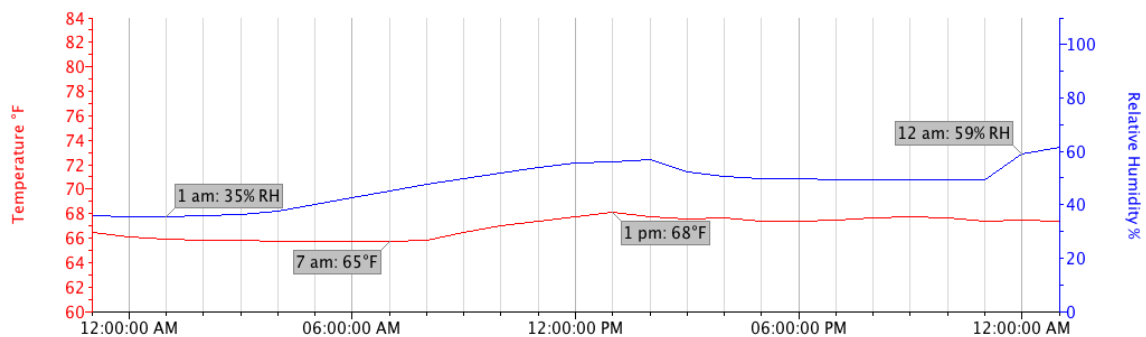

Daily fluctuation: 65-68°F and 35-59% relative humidity

Room 368: 3 Woodcock Audiovisual Stacks

August 2014-July 2015

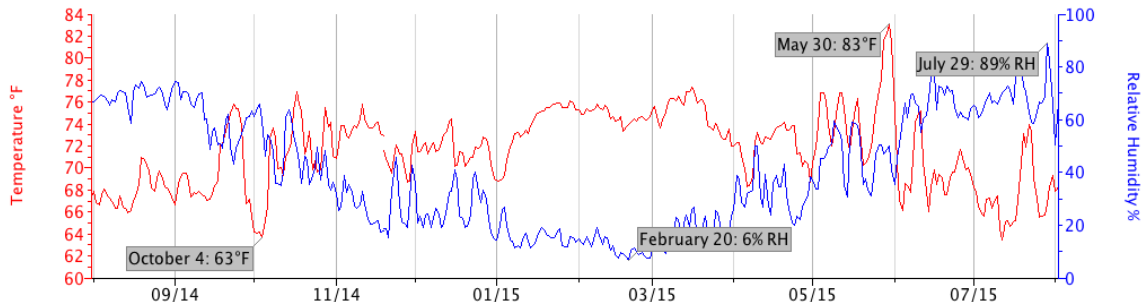

Yearly fluctuation: 63-83°F and 6-89% relative humidity

May 2015

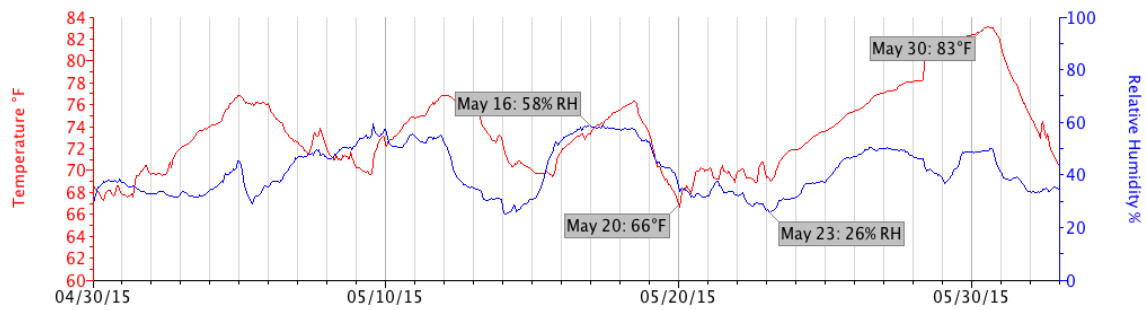

Monthly fluctuation: 62-81°F and 5-80% relative humidity

May 15, 2015

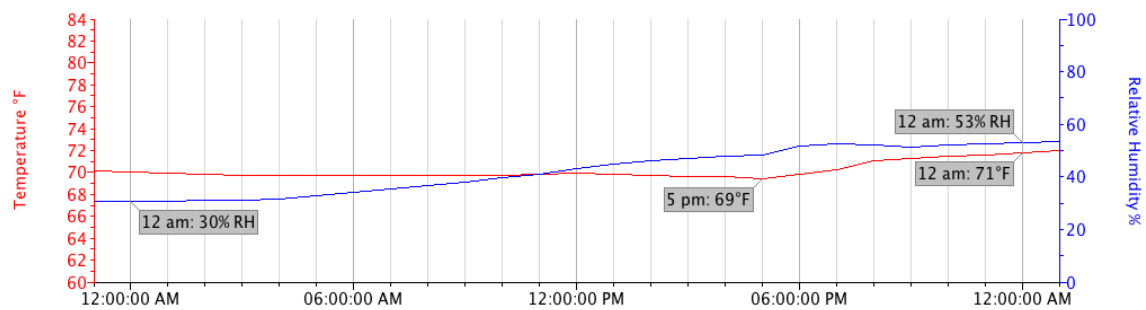

Daily fluctuation: 69-71°F and 30-53% relative humidity

**Walter P. Reuther Library, Archives of Labor and Urban Affairs
Application to the National Endowment of the Humanities
Sustaining Cultural Heritage Collections: Planning Grant**

Conservation and Environmental Condition Assessment

Appendix 7G: Recent Works Citing Reuther Library Collections

Monographs

'40 Ford: Evolution, Design, Racing, Hot Rodding by Joseph P. Cabadas. Motorbooks, 2011.

The 1937 Chicago Steel Strike: Blood on the Prairie by John F. Hogan. History Press, 2014.

Aaron Henry of Mississippi: Inside Agitator by Minion K.C. Morrison. University of Arkansas Press, 2015.

Advertising at War: Business, Consumers, and Government in the 1940s by Inger L. Stole. University of Illinois Press, 2012.

African American Women Educators: A Critical Examination of Their Pedagogies, Educational Ideas, and Activism from the Nineteenth to the Mid-Twentieth Century by Karen A. Johnson, Kenneth L. Johnson, and Abul Pitre. Rowman & Littlefield Education, 2014.

American Labor's Global Ambassadors: The International History of the AFL-CIO During the Cold War by Geert Van Goethem & Robert Anthony Waters, Jr. Palgrave Macmillan, 2013.

Arsenal of Democracy: The American Automobile Industry in World War II by Charles K. Hyde. Wayne State University Press, 2013.

Asian Americans in Michigan: Voices from the Midwest by Sook Wilkinson. Wayne State University Press, 2015.

Autonomous State: The Struggle for a Canadian Car Industry from OPEC to Free Trade by Dimitry Anastakis. University of Toronto Press, 2013.

Barry Goldwater and the Remaking of the American Political Landscape by Elizabeth Tandy Shermer.

Beyond Testimony and Trauma: Oral History in the Aftermath of Mass Violence by Steven High. UBC Press, 2015.

Borderlands Saints: Secular Sanctity in Chicano/a and Mexican Culture by Desiree A. Martin. Rutgers University Press, 2014.

Cesar Chavez and the United Farm Workers Movement by Roger Bruns. Greenwood, 2011.

Challenging Global Capitalism: Labor Migration, Radical Struggle, and Urban Change in Detroit and Turin by Nicola Pizzolato. Palgrave Macmillan, 2013.

The Colonel and Hug: The Partnership That Transformed the New York Yankees by Lyle Spatz and Steve Steinberg. University of Nebraska Press, 2015.

Contesting the Postwar City: Working-Class and Growth Politics in 1940s Milwaukee by Eric Fure-Slocum. Cambridge University Press, 2013.

The Crusades of Cesar Chavez by Miriam Pawel. Bloomsbury Press, 2014.

Curriculum Materials Collection and Centers by Rita Kohrman. Association of College and Research Libraries, 2012.

Death Blow to Jim Crow: The National Negro Congress and the Rise of Militant Civil Rights by Erik S. Gellman. University of North Carolina Press, 2012.

Detroit: Race Riots, Racial Conflicts, and Efforts to Bridge the Racial Divide by Joe T. Darden and Richard W. Thomas. Michigan State University Press, 2013.

Detroitland: A Collection of Movers, Shakers, Lost Souls, and History Makers from Detroit's Past by Richard Bak. Painted Turtle, 2011.

Dispossession: Discrimination Against African American Farmers in the Age of Civil Rights by Pete Daniel. University of North Carolina Press, 2013.

An Education in Politics: The Origins and Evolution of No Child Left Behind by Jesse H. Rhodes. Cornell University Press, 2012.

The Environmental Moment: 1968-1972 by David Stradling. University of Washington Press, 2012.

Feminists Who Changed America, 1963-1975 by Nancy F. Cott and Barbara J. Love. University of Illinois Press, 2015.

Free World?: The Campaign to Save the World's Refugees, 1956-1963 by Peter Gatrell. Cambridge University Press, 2011.

From the Jaws of Victory: The Triumph and Tragedy of Cesar Chavez and the Farm Worker Movement by Matthew Garcia. University of California Press, 2014.

Girls Coming to Tech!: A History of American Engineering Education for Women by Amy Sue Bix. MIT Press, 2014.

The Greening of Architecture: A Critical History and Survey of Contemporary Sustainable Architecture and Urban Design by A. Senem Deviren and Philip J. Tabb. Ashgate Publishing Limited, 2013.

Headstrong: 52 Women Who Changed Science—and the World by Rachel Swaby. Broadway Books, 2015.

Historic Photos of Detroit in the 50s, 60s, and 70s by Mary J. Wallace. Turner Publishing, 2011.

Images from the Arsenal of Democracy by Charles K. Hyde. Painted Turtle, 2013.

LBJ and Grassroots Federalism: Congressman Bob Poage, Race, and Change in Texas by Robert H. Duke. Texas A&M University Press, 2014.

Lettuce Wars by Bruce Neuberger. Monthly Review Press, 2013.

Little 'Red Scares': Anti-Communism and Political Repression in the United States, 1921-1946 by Robert Justin Goldstein

The Making of Black Detroit in the Age of Henry Ford by Beth T. Bates. University of North Carolina Press, 2012.

Making the World Safe for Workers: Labor, the Left, and Wilsonian Internationalism by Elizabeth McKillen. University of Illinois Press, 2013.

The Man Who Never Died: The Life, Times, and Legacy of Joe Hill, American Labor Icon by William M. Adler. Bloomsbury USA, 2012.

Managing Inequality: Northern Racial Liberalism in Interwar Detroit by Karen R. Miller. New York University Press, 2015.

Mao's Little Red Book: A Global History by Alexander C. Cook. Cambridge University Press, 2014.

To March for Others: The Black Freedom Struggle and the United Farm Workers by Lauren Araiza. University of Pennsylvania Press, 2014.

Meet Me at the Fair by Carla Leshne. ETC Press, 2014.

Metropolitan Jews: Politics, Race, and Religion in Postwar Detroit by Corwin L. Berman. University of Chicago Press, 2015.

Money, Trains, and Guillotines: Art and Revolution in 1960s Japan by William Marotti. Duke University Press, 2013.

The Mormon Image in the American Mind: Fifty Years of Public Perception by J.B. Haws. Oxford University Press, 2013.

Nevirapine and the Quest to End Pediatric AIDS by Rebecca J. Anderson. McFarland & Company, 2014.

Once in a Great City: A Detroit Story by David Maraniss. Simon & Schuster, 2015.

Palomino: Clinton Jencks and Mexican-American Unionism in the American Southwest by James J. Lorence. University of Illinois Press, 2013.

The Philosopher-Lobbyist: John Dewey and the People's Lobby, 1928-1940 by Mordecai Lee. State University of New York Press, 2015.

The Political Spirituality of Cesar Chavez: Crossing Religious Borders by Luis D. Leon. University of California Press, 2015.

Prohibition Gangsters: The Rise and Fall of a Bad Generation by Marc Mappen. Rutgers University Press, 2013.

Protesting Affirmative Action: The Struggle Over Equality After the Civil Rights Revolution by Dennis Deslippe. John Hopkins University Press, 2012.

The Principle's Office: A Social History of the American School Principal by Katie Rousmaniere. State University of New York Press, 2013.

Race After the Internet by Lisa Nakamura and Peter Chow-White. Routledge, 2012.

Radical Theatrics: Put-ons, Politics, and the Sixties by Craig J. Peariso. University of Washington Press, 2015.

Relentless Reformer: Josephine Roche and Progressivism in Twentieth-Century America by Robyn Muncy. Princeton University Press, 2015.

Religion, Race, and Barack Obama's New Democratic Pluralism by Gaston Espinosa. Routledge, 2013.

Retiring Men: Manhood, Labor, and Growing Old in America, 1900-1960 by Gregory Wood. University Press of America, 2012.

Sanctuary Practices in International Perspectives: Migration, Citizenship and Social Movements by Randy K Lippert and Sean Rehaag. Routledge, 2013.

Searching for Scientific Womanpower: Technocratic Feminism and the Politics of National Security, 1940-1980 by Laura Micheletti Puaca. University of North Carolina Press, 2014.

The Self-Help Myth: How Philanthropy Fails to Alleviate Poverty by Erica Kohl-Arenas. University of California Press, 2015.

Serbians in Michigan by Paul Lubotina. Michigan State University Press, 2014.

Soapbox Rebellion: The Hobo Orator Union and the Free Speech Fights of the Industrial Workers of the World, 1909-1916 by Matthew S. May. University of Alabama Press, 2013.

Struggle for the Soul of the Postwar South: White Evangelical Protestants by Elizabeth Fones-Wolf and Ken Fones-Wolf. University of Illinois Press, 2015.

The Struggle in Black and Brown: African American and Mexican American Relations During the Civil Rights Era by Brian D. Behnken. University of Nebraska Press, 2011.

Sunshine was Never Enough: Los Angeles Workers, 1880-2010 by John H.M. Laslett. University of California Press, 2012.

Swedes in Michigan by Rebecca J. Mead. Michigan State University Press, 2012.

Teachers United: The Rise of New York State United Teachers by Dennis Gaffney. State University of New York Press, 2012.

Touching the City: Thoughts on Urban Scale by Timothy Makower. John Wiley & Sons, 2014.

Trampling Out the Vintage: Cesar Chavez and the Two Souls of the United Farm Workers by Frank Bardacke. Verso Books, 2011.

The Tribunal Responses to John Brown and the Harpers Ferry Raid by John Stauffer and Zoe Trodd. The Belknap Press of Harvard University Press, 2012.

Uncivil Rights: Teachers, Unions and Race in the Battle for School Equity by Jonna Perrillo. University of Chicago Press, 2012.

Uninvited Neighbors: African Americans in Silicon Valley, 1769-1990 by Herbert G. Ruffin II. University of Oklahoma Press, 2014.

The United States District Court for the Eastern District of Michigan: People, Law, and Politics by David G. Chardavoyne. Wayne State University Press, 2012.

An Unlikely Union: The Love-Hate Story of New York's Irish and Italians by Paul Moses. NYU Press, 2015.

Vendetta: Bobby Kennedy Versus Jimmy Hoffa by James Neff. Little, Brown and Company, 2015.

Yamasaki in Detroit: A Search for Serenity by John Gallagher. Wayne State University Press, 2015.

Journal and Magazine Articles

“The 1939 Trial of Raymond Tessmer: Exemplar of UAW Factionalism” by Robert P. Davidow. *Michigan Historical Review*, Vol. 38, No. 2, Fall 2012.

“AFL Community Unionism: The Des Moines Department Store Strike of 1939” by Matthew M. Mettler. *Labor*, Vol. 11, No. 1, 2014.

“‘Apostles of Fascism,’ ‘Communist Clergy,’ and the UAW: Political Ideology and Working-Class Religion in Detroit, 1919-1945” by Matthew Pehl. *Journal of American History*. Vol. 99, No. 2, 2012.

“As Great an Issue as Slavery or Abolition: Economic Populism, the Conservative Movement, and the Right-to-Work Campaigns of 1958” by Kim Phillips-Fein. *Journal of Political History*, Vol. 23, No. 4, October 2011.

“The Association of (Gay) Suburban People” by Tim Retzliff. *Places Journal*, 2015.

“Big Brother Unionism? The Landrum-Griffin Act and the Fight for AFSME’s Future, 1961-1964” by Joseph E. Hower. *Labor*, Vol. 11, No. 2, 2014.

“Bread, Roses, and Other Possibilities: The 1912 Lawrence Textile Strike in Historical Memory” by Mark W. Robbins. *Historical Journal of Massachusetts*. Vol. 40, No. 1-2, Summer 2012.

“Changing Nature: Union Discourse and the Fermi Atomic Power Plant” by Jacquelyn Southern. *International Labor and Working Class History*, Vol. 85, 2014.

“‘Chrysler Pulled The Trigger’: Competing Understandings of Workplace Violence During the 1970s and Radical Legal Practice” by Jeremy Milloy. *Labour/Le Travail*, Vol. 74, No. 1, Fall 2014.

“Class vs. Special Interest Labor, Power, and Politics in the United States and Canada in the Twentieth Century” by Barry Eidlin. *Politics & Society*, Vol. 43, No. 2, 2015.

“Community and Measured Militancy: The Ventura County Community Service Organization, 1958-1968” by Frank P. Barajas. *Southern California Quarterly*, Vol. 96, No. 3, Fall 2014.

“Critical Ethnic Legal Histories: Unearthing the Interracial Justice of Filipino American Agricultural Labor Organizing” by Marc-Tizoc Gonzalez. *UC Irvine Law Review*, 2013.

“Dark Waters” by Gary Henry. *Concrete International*, Vol. 36, No. 4. April 1, 2014.

“Decline and Renaissance Photographing Detroit in the 1940s and 1980s” by Wes Aelbrecht. *Journal of Urban History*, 2015

“Describing Images: A Case Study of Visual Literacy Among Library and Information Science Students” by Joan E. Beaudoin. *College & Research Libraries*, 2015.

“Dissent in the Coalfields: Miners, Federal Politics, and Union Reform in the United States, 1968-1973” by Richard Fry. *Labor History*, Vol. 55, No. 2, March 2014.

“Driving on Speed: Long-Haul Truck Drivers and Amphetamines in the Postwar Period” by Kevin Riley. *Labor*, Vol. 11, No. 4, 2014.

“Dubious Heritage: Tobacco, History, and the Perils of Remembering the Rural Past” by Evan P. Bennett. *Agricultural History*, Vol. 86, No. 2, Spring 2012.

“Environmental Justice at Work: The UAW, the War on Cancer, and the Right to Equal Protection from Toxic Hazards in Postwar America” by Josiah Rector. *Journal of American History*, Vol. 101, No. 2, September 2014.

“Expressways Before the Interstates: The Case of Detroit, 1945-1956” by Roger Biles. *Journal of Urban History*, Vol. 40, No. 5, September 2014.

“Fraternally Yours: The Union Architecture of Oskar Stonorov and Walter Reuther” by Susan Herrington. *Social History*, Vol. 40, No. 3, 2015.

“Friends and Foes: Religious Publications and the Delano Grape Strike and Boycott (1965-1970)” by Andrew Jacobs. *American Catholic Studies*, Vol. 124, No. 1, Spring 2013.

“From History to Library and Information Science: A Case Study of Archival Education at Wayne State University” by Joseph M. Turrini. *Information & Culture: A Journal of History*. Vol. 47, No. 3, 2012.

“Funding the Other California: An Anatomy of Consensus and Consent” by Erica Kohl-Arenas. *Territories of Poverty: Rethinking North and South*, 2015.

“Giving Consumers a Fair Chance: The Ideological Battle over Mandatory Grading in the 1930s and 1940s” by Inger L. Stole. *Journal of Consumer Affairs*. Vol. 48, No. 1, 2014.

“Governing Poverty Amidst Plenty: Participatory Development and Private Philanthropy” by Erica Kohl-Arenas. *Geography Compass*, Vol. 5, No. 11, 2011.

“Habits of Employees: Smoking, Spies, and Shopfloor Culture at Hammermill Paper Company” by Gregory Wood. *Journal of Social History*, Vol. 45, No. 1, Fall 2011.

“Hands Off the Machine: Workers’ Hand and Revolutionary Symbolism in the Visual Culture of 1930s America” By Max Fraser. *American Art*, Vol. 27, No. 2, Summer 2013.

“The Heyday of the Labor Beat” by David Witwer. *Labor*, Vol. 10, No. 2, 2013.

“‘I Came Like the Thunder and I Vanish Like the Wind’: Exploring Genre Repertoire and Document Work in the Assemblée Operai E Studenti of 1969” by Steve Wright. *Archival Science*, Vol. 12, No. 4, December 2012.

“‘Indiscriminate and Shameless Sex’: The Strategic Use of Sexuality by the United Farm Workers” by Ana R. Minian. *American Quarterly*, Vol. 65, No. 1, March 2013.

“International Labour Organizations in a Global Economy” by Geert Van Goethem. *Historisk Tidskrift*, Vol. 132, No. 2, 2012.

“Jewish Urban Politics in the City and Beyond” by Lila C. Berman. *Journal of American History*, Vol. 99, No. 2, 2012.

“Jobs or Income Now!”: Work, Welfare, and Citizenship in Johnnie Tillmon’s Struggles for Welfare Rights” by Kazuyo Tsuchiya. *The Japanese Journal of American Studies*, No. 22, 2011.

“Labor Makes the News”: Newspapers, Journalism, and Organized Labor, 1933-1955” by Philip M. Glende. *Enterprise & Society*, Vol. 13, No. 1, March 2012.

“Labor Today” by Dorothy Sue Cobble and Michael Merrill. *Pennsylvania Legacies*, Vol. 14, No. 1, Spring 2014.

“Labor’s Pink-Collar Aristocracy: The National Secretaries Association’s Encounters with Feminism in the Age of Automation” by Katherine Turk. *Labor*, Vol. 11, No. 2, 2014.

“Labour Militancy Deferred: Racial State Interventions and the California Farm Worker Struggle” by Adrian Cruz. *Race & Class*, Vol. 56, No. 1, July-September 2014.

“Labor Unions and Race-conscious Housing in the Postwar Bay Area: Housing Projects of the International Longshoremen’s and Warehousemen’s Union and the United Automobile Workers” by Hilary Botein. *Journal of Planning History*, 2015.

“A Landscape of Ruin and Repair: Parks, Potatoes, and Detroit’s Environmental Past, 1879-1900” by Joseph S. Cialdella. *Michigan Historical Review*, Vol. 40, No. 1, Spring 2014.

“Lessons from History: Surviving Old Age During the Great Depression in the United States” by Ruth E. Dunkle and Sarah H. Matthews. *Journal of Aging Studies*, Vol. 27, 2013.

“Locating Douglass Fitch: The Roots of Colour and Activist Traditions of United States Critical Whiteness Studies” by Say Burgin. *Australian Critical Race and Whiteness Studies Association*, Vol. 9, No. 1, 2013.

“Lost Leader in History: The Transforming and Empowering Partnership of Dolores Huerta & Cesar Chavez” by Rebecca Avalos. *McNair Scholars Research Journal*, Vol. 15, June 2011.

“Making Amends: Coal Miners, the Black Lung Association, and Federal Compensation Reform, 1969-1972” by Richard Fry. *Federal History*, 2013.

“Managers and Ministers: Instilling Christian Free Enterprise in the Postwar Workplace” by Elizabeth Fones-Wolf and Ken Fones-Wolf. *Business History Review*, Vol. 89, No. 01, 2015.

“Mixing It Up: Michigan Barmaids Fight for Civil Rights” by Amy H. French. *Mixing Historical Review*, Vol. 4, No. 1, Spring 2014.

“The National Farm Worker Ministry as Freirian Apprenticeship” by Ryan Nilsen. *Religious Education*, Vol. 109, No. 2, 2014.

“Next Practices: Knowledge, Infrastructure, and Public Goods at the Bottom of the Pyramid” by Julia Elyachar. *Public Culture*, Vol. 24, No. 1, 2012.

“No Laughing Matter: The UAW and Gender Construction on Labor Radio in Fifties’ America” by Elizabeth Fones-Wolf. *Labor*, Vol. 8, No. 11, 2011.

“The Northern Promised Land That Wasn’t: Rosa Parks and the Black Freedom Struggle in Detroit” by Jeanne Theoharis. *Magazine of History*, Vol. 26, No. 1, January 2012.

“The Old Normal: Casualization and Contingency in Historical Perspective” by Timothy R. Cain. *Thought & Action*, Summer 2015.

“On the Importance of Affirmative Action: Labor Liberals and the Recasting of ‘Contract Unionism’” by Dennis Deslippe. *Labor*, Vol. 9, No. 2, 2012.

“Organizing Labor and the Origins of the Occupational Safety and Health Act” by Robert Asher. *New Solutions: A Journal of Environmental and Occupational Health Policy*, Vol. 24, No. 3, 2014.

“Organizing the Keystone State: AFSCME and the Campaign for Commonwealth Workers in Pennsylvania” by Francis Ryan. *Pennsylvania Legacies*, Vol. 14, No. 1, Spring 2014.

“Place-Based Education in Detroit: A Critical History of the James & Grace Lee Boggs School” by Christina Van Houten. *Workplace: A Journal for Academic Labor*, Vol. 26, 2015.

“Political Mediation and American Old-Age Security Exceptionalism” by Michael A. McCarthy. *Work and Occupations*, Vol. 41, No. 2, 2014.

“Poverty, Housing, and the Rural Slum: Policies and the Production of Inequities, Past and Present” by Sarah M. Ramirez. *American Journal of Public Health*. Vol. 102, No. 9, September 2012.

“Producing Memory: Public History and Resistance in a Canadian Auto Town” by Christine McLaughlin. *Oral History Forum*, 2012.

“Production and Reproduction, Home and Work” by Eileen Boris. *Tempo Social*, Vol. 26, No. 1, 2014.

“Progressive Policy Making in a Conservative Age? Civil Rights and the Politics of Federal Education Standards, Testing, and Accountability” by Jesse Hessler Rhodes. *Perspectives on Politics*, Vol. 9, No. 3, September 2011.

“Public Sector Collective Bargaining, Majoritarianism, and Reform” by Daniel M. Rosenthal. *Oregon Law Review*, Vol. 91, No. 3, March 1, 2013.

“Publicity, Recruitment, and History: Society of Women Engineers” by Troy Eller. *Centaurus*, Vol. 54, No. 4, November 2012.

“Radical Border Crossers: The Industrial Workers of the World and their Press in Latin America” by Anton Rosenthal. *Estudios Interdisciplinarios de America Latina y el Caribe*, Vol. 22, No. 2, 2011.

“The Refusal of Work: From the Postemancipation Caribbean to Post-Fordist Empire” by Christopher Taylor. *Small Axe*, Vol. 18, No. 2, July 2014.

“Researching Environmental Justice: A Conversation” by William W. LeFevre and Virginia C. Thomas. *Michigan Bar Journal*, Vol. 93, No. 9, September, 2014.

“Rhetorical Functions of Letter Writing: Dialogic Collaboration, Affirmation, and Catharsis in Dolores Huerta’s Letters” by Stacey K. Sowards. *Communications Quarterly*, Vol. 60, No. 2, April 2012.

“Safe Seizures, Schoolyard Stoics, and the Making of Contained Citizens at Detroit’s School for Epileptic Children, 1933-1956” by Rachel Elder. *Journal of the History of Childhood and Youth*, Vol. 7, No. 3, Fall 2014.

“Segregation as Splitting, Segregation as Joining: Schools, Housing, and the Many Modes of Jim Crow” by Andrew R. Highsmith and Ansley T. Erickson. *American Journal of Education*, Vol. 121, No. 4, August 2015.

“‘A Sense of Possibility and a Belief in Collective Power’: A Labor Strategy Talk with Karen Nussbaum” by Lane Windham. *Labor*, Vol. 12, No. 3, 2015.

“Serigrafia: Constructing the Chicana/o Imaginary” by Carlos F. Jackson. *Boom: A Journal of California*, Vol. 4, No. 1, Spring 2014.

“Shredding the White and Blue: American Migration and Soviet Dreams in the Era of the New Economic Policy by Benjamin W. Sawyer. *Ab Imperio*, January 2013.

“‘A Story of Ordinary Human Beings’: The Sources of Du Bois’s Imagination in Black Reconstruction” by Thomas C. Holt. *South Atlantic Quarterly*, Vol. 112, No. 3, 2013.

“Strange Bedfellows at Work: Neomaternalism in the Making of Sex Discrimination Law” by Deborah Dinner. *Washington University Law Review*, Vol. 91, No. 3, 2014.

“Teachers’ Curricular Choices when Teaching Histories of Oppressed People: Capturing the U.S. Civil Rights Movement” by Katy Swalwell, Anthony M. Pellegrino, and Jenice L. View. *Journal of Social Studies Research*, Vol. 39, No. 2, 2015.

“Thelma Estrin and the Origins of Biomedical Computing [Scanning Our Past]” by Alexander B. Magoun. *Proceedings of the IEEE*. Vol. 103, No. 6, 2015.

“Third World Alliances: Arab-American Activists in American Universities, 1967-1973” by Pamela Pennock. *Mashriq & Mahjar: Journal of Middle East Migration Studies*, Vol. 2, No. 2, 2014.

“Trouble on the Right, Trouble on the Left: The Early History of the American Newspaper Guild” by Philip M. Glende. *Journalism History*, Vol. 38, No. 3, Fall 2012.

“UELMA: The Uniform Electronic Legal Material Act” by Marlene Coir and Virginia C. Thomas. *Michigan Bar Journal*, Vol. 93, No. 10, October 2014.

“Unionised Faculty and the Political Left: Communism and the American Federation of Teachers on the Eve of the Second World War” by Timothy R. Cain. *History of Education*, Vol. 41, No. 4, July 2012.

“The Variegated Shoots: Hazel MacKaye and the Advent of Pedagogical Drama at Brookwood Labor College, 1925-1926” by Mary McAvoy. *Youth Theatre Journal*, Vol. 29, No. 1, 2015.

“Will the Revolution be Funded? Resource Mobilization and the California Farm Worker Movement” by Erica Kohl-Arenas. *Social Movement Studies*, Vol. 13, No. 4, 2014.

“A Woman’s Place is in Her Union: The UAW’s 1944 National Women’s Conference and Women’s Labor Activism” by Tiffany Baugh-Helton. *Michigan Historical Review*, Vol. 40, No. 1, Spring 2014.

“Women in Engineering: The Illusion of Inclusion” by Troy Eller, Lisa M. Frehill, Ph.D., and Cheryl Leggon, Ph.D. *Journal of the Society of Women Engineers*, Vol. 5, 60th Anniversary Edition, 2011.

Feature Films

Cesar Chavez by Diego Luna. Lionsgate, 2014.

Sparkle by Salim Akil. Sony Pictures Entertainment, 2012.

Documentary Films

10 Buildings That Changed America. PBS, 2013.

American Revolutionary: The Evolution of Grace Lee Boggs by Grace Lee. LeeLee Films, 2013.

The Black Panthers: Vanguard of the Revolution by Stanley Nelson. PBS, 2015.

Brothers on the Line by Sasha Reuther. Porter Street Pictures, 2011.

Carol Channing: Larger Than Life by Dori Berinstein. Dramatic Forces, 2011.

Cesar's Last Fast by Lorena Parlee and Richard Ray Perez. Monkey Mind Media, 2014.

A Faster Horse by David Gelb. White Horse Pictures, 2015.

Killing Jimmy Hoffa by Al Profit. Indie Rights, 2014.

Purple: Organized Crime in a Small Town by Benjamin Tigner. Central Michigan University, 2012.

Requiem for Detroit? by Julien Temple. BBC, 2010.

Searching for Sugar Man by Malik Bendjelloul. Sony Pictures Classics, 2012.

Television Programs

The African-Americans: Many Rivers to Cross with Henry Louis Gates, Jr. PBS, 2013.

American Experience: Henry Ford. PBS, 2013.

Forgotten Planet. Discovery Channel, 2011.

History Detectives. PBS, 2012 and 2014.

The Italian Americans. PBS, 2014.

Latino Americans. PBS, 2013.

Latino List: Volume 2. HBO, 2012.

Makers. PBS, 2013.

Mobster Confessions. Discovery Channel, 2015.

Mysteries at the Museum. Travel Network, 2010.

The Oprah Winfrey Show. Harpo Productions, 2011.

Sound Tracks: The Rock & Roll Hall of Fame & Museum. PBS, 2015.

**Walter P. Reuther Library, Archives of Labor and Urban Affairs
Application to the National Endowment of the Humanities
Sustaining Cultural Heritage Collections: Planning Grant**

Conservation and Environmental Condition Assessment

Appendx 7H: Letters of Support

- 1) Dr. M. Roy Wilson, President, Wayne State University
- 2) Dr. Margaret Winters, Provost and Vice President for Academic Affairs
- 3) Dr. Sandra Yee, Dean of Libraries, Wayne State University
- 4) Deb Brazen, Director, Planning and Estimating, Wayne State University
- 5) Frank Boles, Director, Clarke Historical Library, Central Michigan University
- 6) Nancy Barr, Curator, Detroit Institute of Arts
- 7) Leslie Edwards, Cranbrook Educational Community
- 8) Roberta Frey Gilboe, University of Michigan Museum of Art



Office of the President

4200 Faculty/Administration Building
Detroit, MI 48202
313-577-2230
Fax: 313-577-3200

November 20, 2015

Joel Wurl, Sr. Program Officer
Division of Preservation & Access
National Endowment for the Humanities
400 7th Street SW
Washington, DC 20506

Dear Joel:

I want to provide my support for this application to the National Endowment of the Humanities for a planning grant in the Sustaining Cultural Heritage Collections program of the Division of Preservation and Access. The proposed project will complete an assessment of environmental control and collections preservation problems in the Walter P. Reuther Library.

A manuscript and historical archives is one of the many research facilities of a modern university campus. Wayne State University has made a significant investment in gathering these resources and realizes its serious responsibility to care for these portions of our shared cultural record.

The resources of the Reuther Library embody the mission of Wayne State University to create and advance knowledge, prepare a diverse student body to thrive, and positively impact local and global communities. These collections, documenting the history of Wayne State University, the urban affairs of Metropolitan Detroit, and North American labor, support our work in community engagement as well as the research and learning goals of our institution.

As you will see in the project budget, Wayne State University is committing an equal share of the costs for this project. This reflects our serious commitment to addressing the needs for the long-term conservation of these significant and unique humanities collections. These are complex issues requiring the creative input of facilities, engineering, conservation, and archival professionals. We believe that the proposed work will provide a needed foundation from which to plan and implement a variety of subsequent projects which will directly impact the physical conservation of these important and unique resources

We appreciate the opportunity to partner with the NEH in this important work.

Sincerely,

M. Roy Wilson, M.D., M.S.
President



Office of the Provost
656 W. Kirby
4092 Faculty Administration Building

November 20, 2015

Joel Wurl, Sr. Program Officer
Division of Preservation & Access
National Endowment for the Humanities
400 7th Street SW
Washington, DC 20506

Dear Joel:

My office fully supports this application for a planning grant from the Sustaining Cultural Heritage Collections program of the Division of Preservation and Access of the National Endowment of the Humanities. The project to complete a conservation and environment condition assessment of the collections and storage environments at the Walter P. Reuther Library is a critical next step in Wayne State University's commitment to address persistent environmental control and collections preservation problems in the Walter P. Reuther Library's original 1975 building and its 1991 addition.

As a scholar in the field of modern languages and linguistics, my research has brought me into contact with a wide variety of manuscript material in many different repositories around the world. Although my specific research agenda engages a very different range of historical resources, those materials have been carefully preserved in archives at universities and other cultural institutions. It is part of our university concept to commit local resources to the collection and preservation of portions of this international cultural record. Wayne State University has committed significant resources to the collection of labor, urban affairs, and University history at the Reuther Library.

We take our responsibility for the care and protection of these significant humanities resources very seriously, and are willing to commit university resources to match an NEH grant for the proposed assessment. The work does not end with the completion of this project, however. This conservation and environmental condition assessment project will provide a needed framework for a variety of subsequent initiatives to improve preservation conditions and ensure that these unique historical resources will be available to faculty, students, scholars and the general public.

We look forward to the support of the National Endowment for the Humanities. Don't hesitate to contact me for any further information about this important project.

Sincerely,

A handwritten signature in blue ink that reads "Margaret E. Winters".

Margaret E. Winters
Provost and Senior Vice President for Academic Affairs

WAYNE STATE
UNIVERSITY
LIBRARY SYSTEM

- Office of the Dean
University Libraries

November 20, 2015

Joel Wurl, Sr. Program Officer
Division of Preservation & Access
National Endowment for the Humanities
400 7th Street SW
Washington, DC 20506

Dear Joel:

This letter is in support of the application from the Walter P. Reuther Library, Archives of Labor and Urban Affairs for a planning grant in the Sustaining Cultural Heritage Collections program of the Division of Preservation and Access of the National Endowment of the Humanities. The Reuther Library is one of five libraries in the Wayne State University Library System which report to me as Dean of the University Library System.

We are committed to addressing the continued collections preservation problems in the Reuther Library's original 1975 building and its 1991 addition. This ongoing situation poses serious consequences for the long-term conservation of the significant and unique humanities collections held in this central archival repository for labor, urban affairs, and University history. Our project will complete an external professional conservation and environment condition assessment of the collections and storage environments at the Reuther Library. This, in turn, will establish a critical baseline for subsequent work to improve collections conditions.

Having worked in academic libraries for more than 30 years, I have witnessed a transformation in the ways that faculty, students and the general public access and use information in ubiquitous digital and web-based formats. These changes continue to underline, however, the importance of the unique manuscript materials held by archival repositories such as the Reuther Library. Whereas some institutions may choose to abrogate their role in preservation by merely purchasing licensed access to packaged digital content, Universities such as ours have a responsibility to adequately protect and care for the tangible historical resources entrusted to us by individuals and organizations.

We view this work in a longer framework of incremental and component effort over the years to come. This initial, comprehensive assessment is key to this work, so much so that we will commit the financial resources necessary to complete this work, utilizing both cash and in-kind resources.

Sincerely,

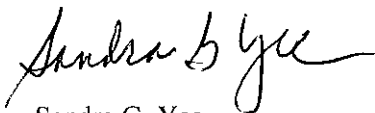

Sandra G. Yee
Dean, University Libraries

November 20, 2015

Joel Wurl, Sr. Program Officer
Division of Preservation & Access
National Endowment for the Humanities
400 7th Street SW
Washington, DC 20506

Dear Mr. Wurl,

The Design and Construction Services (D&CS) Division of Wayne State University's Facilities Planning and Management (FP&M) Department offers our strong support regarding the Walter P. Reuther Library's application for a planning grant from the Sustaining Cultural Heritage Collections program of the Division of Preservation and Access of the National Endowment of the Humanities.

It has been our pleasure to assist in the planning and pre-design of this proposal. The conservation and environment condition assessment of the collections and storage area environments at the Walter P. Reuther Library is critical. The Reuther Library opened in 1975, with the Woodcock Wing addition added in 1991, and the building remains largely unchanged from the original construction. The existing environmental conditions put the artifacts at risk. Wayne State University is committed to identifying and working to address environmental control and collections preservation issues at the Reuther Library.

WSU has committed resources to the collection of labor, urban affairs, and University history at the Reuther Library. The Facilities Planning and Management Department is committed to maintenance and improvement of its physical facilities, and has a demonstrated track record of exploring and implementing sustainable practices. We have a number of LEED-certified buildings on campus, and a commitment from the Board of Governors to achieve no less than LEED Silver with new construction projects.

As to specific personnel, Christa Azar, RA, a project planner from our office, will provide coordination between Reuther Library staff, FP&M staff, and representatives from SmithGroupJJR. We will also draw upon the professional expertise of a variety of staff in our division, including Randy Paquette, Senior Director of D&CS, Mark Allen, P.E., Senior Director of Facilities Operations, Steven Pecic, RA, Director of Engineering, and Mark Bobick, Associate Director of Engineering. I will provide administrative input and additional expertise to the project as needed. I am a registered architect and a LEED Accredited Profession in Building Design and Construction. I currently hold certifications with the National Council of Architectural and Records Board (NCARB) and National Council for Interior Design Qualification (NCIDQ) as well.

I fully support this grant application and look forward to participating in this project. Please feel free to contact me for any additional information regarding this important endeavor.

Sincerely,



Deborah Brazen, RA
Director, Planning and Estimating

CC: James Sears, Associate Vice President, Facilities Planning and Management
Randy Paquette, Senior Director, Design and Construction Services, FP&M



November 13, 2015

Joel Wurl, Sr. Program Officer
Division of Preservation & Access
National Endowment for the Humanities
400 7th Street SW
Washington, DC 20506

Dear Joel:

I would like to offer my support to the Walter P. Reuther Library's application for a planning grant from the Sustaining Cultural Heritage Collections program of the Division of Preservation and Access of the National Endowment of the Humanities. In addition, I will commit to serve on an advisory group which will help to monitor the project, including my participation in meetings, phone conferences, and the review of project documentation.

Wayne State University has committed significant resources to the collection of labor, urban affairs, and University history at the Reuther Library. This conservation and environment condition assessment of the collections and storage environments at the Walter P. Reuther Library is a critical next step in Wayne State University's commitment to address persistent environmental control and collections preservation problems in its original 1975 building and its 1991 addition.

I look forward to participating in this project. Don't hesitate to contact me for any further information about this important project.

Sincerely,

A handwritten signature in cursive script, appearing to read "Frank Boles", followed by a horizontal line.

Dr. Frank Boles
Director

November 13, 2015

Joel Wurl, Sr. Program Officer
Division of Preservation & Access
National Endowment for the Humanities
400 7th Street SW
Washington, DC 20506

Dear Joel:

I would like to offer my support to the Walter P. Reuther Library's application for a planning grant from the Sustaining Cultural Heritage Collections program of the Division of Preservation and Access of the National Endowment of the Humanities. In addition, I will commit to serve on an advisory group that will help to monitor the project, including my participation in meetings, phone conferences, and the review of project documentation.



Wayne State University has committed significant resources to the collection of labor, urban affairs, and University history at the Reuther Library. This conservation and environment condition assessment of the collections and storage environments at the Walter P. Reuther Library is a critical next step in Wayne State University's commitment to address persistent environmental control and collections preservation problems in its original 1975 building and its 1991 addition.

I look forward to participating in this project. Don't hesitate to contact me for any further information about this important project.

Sincerely,

A handwritten signature in blue ink that reads 'Nancy Barr'.

Nancy Barr
Co-Chief Curator, Curator of Photography
Department of Prints, Drawings and Photographs

CRANBROOK

ACADEMY OF ART
ART MUSEUM
BROOKSIDE LOWER SCHOOL
CENTER FOR COLLECTIONS AND RESEARCH
CRANBROOK KINGSWOOD MIDDLE SCHOOL
CRANBROOK KINGSWOOD UPPER SCHOOL
INSTITUTE OF SCIENCE

39221 Woodward Avenue

Mail Correspondence to:

P O Box 801

Bloomfield Hills

Michigan 48303.0801

U S A

Office 248 645. 3319

Fax 248 645. 3324

November 16, 2015

Joel Wurl, Sr. Program Officer
Division of Preservation & Access
National Endowment for the Humanities
400 7th Street SW
Washington, DC 20506

Dear Joel:

**CENTER FOR
COLLECTIONS
AND RESEARCH**

I would like to offer my support to the Walter P. Reuther Library's application for a planning grant from the Sustaining Cultural Heritage Collections program. In addition, I will commit to serve on an advisory group which will help to monitor the project, including my participation in meetings, phone conferences, and the review of project documentation.

Wayne State University has committed significant resources to the collection of labor, urban affairs, and University history at the Reuther Library. This conservation and environment condition assessment of the collections and storage environments at the Reuther Library is a crucial next step in the University's commitment to address persistent environmental control and collections preservation problems in its original 1975 building and its 1991 addition.

My work at Cranbrook Archives has included attention to the preservation and conservation needs of collections in my care, which has included paper, photographic, and three-dimensional objects. Working within our historic campus architecture has exposed me to the larger challenges of storage environments. In addition, Cranbrook has undertaken several relative facilities projects during which I have worked with The Smith Group. I feel certain that I can provide useful perspective to this project at Wayne State University.

I look forward to participating in this project. Please feel free to contact me for any further information about this important project.

Sincerely,



Leslie S. Edwards

Head Archivist, Cranbrook Archives

November 24, 2015

Joel Wurl, Sr. Program Officer
 Division of Preservation & Access
 National Endowment for the Humanities
 400 7th Street SW
 Washington, DC 20506

Dear Joel:

I would like to offer my support to the Walter P. Reuther Library's application for a planning grant from the Sustaining Cultural Heritage Collections program of the Division of Preservation and Access of the National Endowment of the Humanities. In addition, I will commit to serve on an advisory group, which will help to monitor the project, including my participation in meetings, phone conferences, and the review of project documentation.

Wayne State University has committed significant resources to the collection of labor, urban affairs, and University history at the Reuther Library. This conservation and environment condition assessment of the collections and storage environments at the Walter P. Reuther Library is a critical next step in Wayne State University's commitment to address persistent environmental control and collections preservation problems in its original 1975 building and its 1991 addition.

As my resume shows, I will bring many years of education and experience in the area of managing collections of works on paper and cultural collections care. Additionally, I have previously worked on a project at Cranbrook Art Museum to build environmentally sound storage for the works on paper in the Art Museum's collection. In the process of planning and implementing that project, I spent a considerable amount of time thinking about the best practices for managing works on paper.

I would be honored to participate in a project that assists in planning for the future of such an important institution in Detroit. Do not hesitate to contact me for any further information about this important project, my direct number is 734-764-1178 and my email is rgilboe@umich.edu.

Sincerely,



Roberta Frey Gilboe
 Chief Registrar, Collections and Exhibitions

**Walter P. Reuther Library, Archives of Labor and Urban Affairs
Application to the National Endowment of the Humanities
Sustaining Cultural Heritage Collections: Planning Grant**

Conservation and Environmental Condition Assessment

Appendix 7I: Resumes of Principal Participants

- 1) Erik Nordberg, Reuther Library, Wayne State University
- 2) Troy Eller English, Reuther Library, Wayne State University
- 3) Deb Brazen, Facilities Planning & Management, Wayne State University
- 4) Christa Azar, Facilities Planning & Management, Wayne State University
- 5) Kevin Shultis, The Smith Group
- 6) Frank Boles, Clarke Historical Library, Central Michigan University
- 7) Nancy Barr, Detroit Institute of Arts
- 8) Leslie Edwards, Cranbrook Educational Community
- 9) Roberta Frey Gilboe, University of Michigan Museum of Art

ERIK NORDBERG

Walter P. Reuther Library
5401 Cass Avenue
Detroit, MI 48207
erik.nordberg@wayne.edu
313-577-2013

22501 Benjamin Street
St. Clair Shores, MI 48081
enordber@mtu.edu
enordber906@gmail.com
906-231-7256

PROFESSIONAL WORK EXPERIENCE

Wayne State University, Detroit, Michigan
- Director, Walter P. Reuther Library of Labor and Urban Affairs, October 2014-Present

Michigan Humanities Council, Lansing, Michigan
- Executive Director, May 2013–October 2014

Michigan Technological University, Houghton, Michigan
- University Archivist and Head of Archives, January 1997–April 2013
- Interim Head of Reference, Instruction, and Government Documents,
August 2009–May 2011
- Acting Library Director, Van Pelt & Opie Library, June–September 2008
- Local Collections Archivist, November 1994–December 1996

Indiana University South Bend
- Assistant Librarian, Archives/Special Collections, February 1993–November 1994

EDUCATION

Michigan Technological University, Houghton, Michigan
Doctoral candidate, program of Industrial Heritage and Archaeology, Social Sciences Department.
Comprehensive examinations completed October 2012, dissertation proposal approved April 2014, expected degree completion May 2016.

Wayne State University, Detroit, Michigan
Master of Science Library Science and Certificate of Archival Administration, May 1992

University Of Dublin, Trinity College, Dublin, Republic of Ireland
Master of Philosophy – Anglo-Irish Literature, December 1988

University Of Ulster at Jordanstown, County Antrim, Northern Ireland
Bachelor of Arts (Honors) in Combined Humanities, July 1987

SELECTED GRANTS & PROJECT MANAGEMENT

“Walter P. Reuther Library Oral History Description and Access Project” (Wayne State University), \$289,342 total project value / \$109,152 from National Historical Publications and Records Commission, Award No. RH50094-14, expected completion December 2016.

- “Michigan Labor Mural Restoration Project” (Wayne State University), \$50,000 total project value / \$21,031 cash gift from the United Auto Workers / \$22,500 Program for Operational and Project Support, Michigan Council for Arts and Cultural Affairs, Award No. 160P3255PS, expected completion June 2016.
- “Latino Americans: 500 Years of History” (Wayne State University), \$10,535 total project value / \$10,000 funding from the American Library Association, Award No. LA105910, expected completion May 2016.
- “Exploring The History of All Michigan’s People” (Michigan Humanities Council), racial history re-grant program to smaller grassroots organizations, W.K. Kellogg Foundation, \$1.7 million total project value (no match required). WKKF Grant Award No. P3029509, expected completion June 2017.
- “Extracting Buried Treasure: Enhancing Access to Manuscripts about Michigan's Copper Country” (Michigan Technological University), \$339,290 total project value / \$168,287 from National Historical Records and Publications Commission, Award No. NAR11-RP-50064-11, completed June 2014.
- “Turning Point in History: The 1913 Michigan Copper Miners’ Strike” (Michigan Technological University), \$28,495 total project value / \$14500 from Michigan Humanities Council, Grant No. 2893, completed May 2013.
- “Coming to the Surface: Revealing Hidden Collections in Michigan’s Copper Country” (Michigan Technological University), \$250,342 total project value / \$116,500 from National Historical Records and Publications Commission, Award No. PG-50268-08, completed October 2011.
- “An Interior Ellis Island: Ethnic Diversity and the Peopling of Michigan’s Copper Country” (Michigan Technological University), \$34,217 total project value / \$15,000 from Michigan Humanities Council, Grant No. 2522 H 04 completed December 2006. Project selected for a 2007 Award of Merit from the American Association for State and Local History.
- “Environmental Monitoring, Damage Mitigation, and Disaster Response Preparation for Archival Collections at Michigan Technological University” (Michigan Technological University), Preservation Assistance grant program, \$7,483 total project value / \$4,797 from , National Endowment for the Humanities, Award No. PG-50268-08, completed June 2009.
- “Preservation Needs Assessment for Archival Collections at Michigan Technological University” (Michigan Technological University), Preservation Assistance grant program, \$7,511 total project value / \$4,974 from National Endowment for the Humanities, Award No. PA-50219-04 completed June 2006.

GRANT REVIEW AND EVALUATION

National Endowment for the Humanities, National Historical Publications and Records Commission, American Library Association, Michigan Humanities Council, Michigan State Historical Records Advisory Board, Michigan Council for Arts and Cultural Affairs, Arts Council of Greater Lansing.

AWARDS

- Recipient of the 2013 Rodman Paul Award from the Mining History Association for outstanding contributions to mining history.
- Recipient of the 2011 Charles Follo Award from the Historical Society of Michigan for outstanding contributions to the preservation and promotion of Upper Peninsula history.
- Recipient of a 2007 Award of Merit from the American Association for State and Local History for the “Interior Ellis Island” ethnic immigration web project.
- Recipient of the 1999 John Townley Award from the Mining History Association for the best article in their annual *Mining History Journal*. Awarded for “The Arizona & Michigan Mining Company, Globe District, Arizona Territory: A Study of a Small Mine in a Large Network,” *1999 Mining History Journal*.

Troy A Eller English

729 S. Pleasant St., Royal Oak, MI 48067 ♦ (810) 429-8715 ♦ ellertro@gmail.com

Professional Experience

Society of Women Engineers Archivist, Wayne State University 2008 – present

- Manage Society of Women Engineers (SWE) collection, arrange and describe records, and manage information requests, from both inside and outside of SWE
- Manage historical projects, archival programs, oral history projects, exhibits, and consult on records management program
- Perform extensive outreach by promoting the SWE traveling exhibit, disseminating information on SWE's archives, maintaining and updating SWE archives information for the Web, and working on other publicity-related items, especially related to *SWE Magazine*
- Chair the Building and Disaster team; coordinate evacuation, disaster, and collection recovery preparations; maintain data loggers and report on environmental monitoring
- Help in the daily operations of the library, including general reference requests, and perform other duties as assigned

Reference Librarian, Baker College of Auburn Hills 2006 – 2014

- Assist students in finding and using print and electronic resources, teach bibliographic instruction sessions, and help students with computing
- Maintain legal materials and purchase books in history, human services, psychology, and early childhood education
- Help in the daily operations of the library and perform other duties as assigned

Graduate Student Assistant, Adamany Undergraduate Library, Wayne State University 2006-2007

- Assist students and community members in finding and using print and electronic materials and requesting books through interlibrary loan, maintain the reference collection, and assist patrons in navigating the university hierarchy
- Teach workshops on beginning Microsoft Word, maintain GSA blog, and perform other duties as assigned by librarians, including evaluating the humanities collection, appraising book donations, and weeding the film strip collection

Education

Wayne State University, Detroit, Michigan

Master in Library and Information Science and Graduate Certificate in Archival Administration, 2007

Michigan State University, East Lansing, Michigan

Bachelor of Arts in English, cognate studies in History, Geography, and German, 2004

Professional Associations

Society of American Archivists 2008 – present

- SAA Key Contact, 2010 – 2013

Midwest Archives Conference 2008 – present

- Assistant Editor, *MAC Newsletter*, 2010 – present

Michigan Archival Association 2008 – present

Community Service Based on Professional Training

Canadian Women in STEM Archives Task Force 2014-present

- Archival consultant

Detroit Jewish News Foundation Technical Advisory Board 2014-present

- Technical consultant on database user interfaces, etc.

Detroit Curling Club 2011-present

- Maintain DCC Rockettes archives

Michigan History Day 2011, 2013

- State finals judge

Selected Publications and Presentations

Perusek, A. & Eller English, T. (eds). (2015) *We Built This: A Look at the Society of Women Engineers' First 65 Years*. Chicago: Society of Women Engineers.

"Petticoats and Slide Rules in the Age of Jeans and iPads: Exploring the Potential for Archives of Women in STEM in the 21st Century." Keynote Speaker, Creating the Memories and Celebrating the Legacy of the Bold and the Brave: Building the Archives of Women Scientists and Engineers in Canada Workshop. Ottawa, ON, Canada. September 11-12, 2014.

"ERA Yes? Revolution and Status Quo in the Society of Women Engineers." Presenter, Great Lakes History Conference. Grand Rapids, MI. October 11, 2012.

Eller, T. (2012). Publicity, recruitment, and history: Society of Women Engineers. *Centaurus*, 54, 299-304.

Panelist, "The Impact of New Archival Projects: U.S. Archives for Women in Science and Engineering in the Late 20th and Early 21st Centuries," International Symposium: Women and Gender Studies - Where Do We Stand? Commission on "Women in Science, Technology, and Medicine, Division of History of Science and Technology of the International Union of History and Philosophy of Science, Paris, France, September 15, 2011

DEBORAH BRAZEN

EDUCATION/ LICENSURE/ CERTIFICATES

NCIDQ Certified Sept. 2007

LEED Accredited Professional Oct. 2006

Licensed as an Architect in Michigan Oct. 2006

Wayne State University

Detroit, MI

Masters of Art in Dispute Resolution

Boston Architectural College

Boston, MA

Bachelors Certificate in Sustainability

Lawrence Technological University

Southfield, MI

Masters of Architecture

with a focus on Construction Management

B.S. in Architecture

B.S. in Interior Architecture

EXPERIENCE

May 2012 – Present

Wayne State University Facilities Planning & Management

Design and Construction Services, Detroit, MI

- Director, Planning and Estimating

Nov. 2010 – May 2012

Wayne State University Facilities Planning & Management

Design and Construction Services, Detroit, MI

- Senior Project Manager/ R-FaST/ Planning

Oct. 2004 – Oct. 2010

Wayne State University Facilities Planning & Management

Design and Construction Services, Detroit, MI

- planning and project management

- responsible for reviewing signage, finishes and furniture

July 2004 – Sept. 2009

International Academy of Design and Technology, Troy, MI

- Adjunct Faculty/ Interior Design Program

Aug. 2001 – Oct. 2004

DSA Architects /SHW Group, Berkley, MI

- Intern Architect and Interior Designer

July 2000 - May 2001

AZD Associates Architects, Birmingham, MI

- Intern Architect and Interior Designer

Aug. 1998-June 2000

David Lavender Architects, P.C., Grosse Pointe Farms, MI

- Intern Architect

PROFESSIONAL DEVELOPMENT

MiAPPA Winter 2014 Presentation of R-FaST Process

USGBC–Detroit Regional Chapt. member 2008-2011, 2013-pres.

Ferndale Planning Commission member June 2006 – present

Explorathon! presenter 2004 - 2012

Finish 2 Fashion/ IIDA participant 2007, 2010

Detroit Storefront Design Competition participant 2009

'Green' lecture presentation to WSU 3/2005, 2/2007

LECTURES/ WORKSHOPS ATTENDED

MiAPPA Conferences: Summer/ Mackinac 2014, Grand Rapids 2013

Academic Impressions: Designing STEM Facilities, Feb. 2014

Tradeline: Science Facilities Conference 2010, 2011

Greenbuild Boston 2008

NeoCon conference and lectures 2006, 2009, 2011, 2013

REFERENCES

Available upon request

Christa D. Azar, R.A.
Wayne State University
Facilities Planning and Management
Design & Construction Services

Work (313) 577-7665
e-mail ba7108@wayne.edu

EDUCATION and LICENSURE

Master of Architecture, University of Detroit Mercy
Bachelor of Architecture, University of Detroit Mercy
Associates Degree in Liberal Arts, Macomb Community College
Professional Registration, Architect, Michigan 1999

EMPLOYMENT

Project Planner

Wayne State University, Detroit, MI

April 2006 - Present

Facilities Planning & Management, Design & Construction Services

Responsible to lead major and minor capital projects and infrastructure improvements on the main campus comprised of 120 buildings over 200 acres. Duties include: developing work scope, cost control, schedule management, communications, coordination with risk management, procurement, and human / technology resource management.

- Administer professional services and construction contracts, manage bid and construction activities.
- Review and analyze drawings and specifications, for construction or operation problems, and for conformance with building and other safety and regulatory codes.
- Develop and monitor project budgets schedules.
- Create quality control procedures, policies and standards.
- Create, present and maintain reports for communication across design, operations and maintenance, and university departments.
- Supervise work activities staff engaged in wide variety of tasks.

PROJECT HIGHLIGHTS

Infrastructure Improvement Projects | Budgets: \$50,000 to \$1M:

- Develop deferred maintenance recommendations of \$7M to \$10M annually. Determine feasibility and prioritize mechanical, electrical and utility upgrades. Develop budget, schedule and design criteria. Develop and implement Curb Appeal high-impact minor improvement (<\$25,000) projects.
- Manage ADA compliance campus-wide and multiple small barrier-removal projects with annual budget of \$150,000. Act as liaison to Advisory Committee for ADA Facilities Compliance.
- Plan variety of research, academic, administrative, housing, technology, parking and site projects.
- Currently managing two \$250,000 classroom improvement projects, and multiple other expansions, renovations, utility upgrades, and life safety improvements with attention to scope, schedule and budget.

PROJECT HIGHLIGHTS (Continued)

Major Capital Improvement Projects | Budgets: \$2M to \$26M

- Participate with campus Development to prepare major expansion feasibility studies and department master plans. Participate with Operations, Maintenance and trades on infrastructure, Fire Suppression, Fire Alarm, Building Envelope and Utility upgrades.
- Advanced Energy Technology Center (ATEC – Macomb South) RENOVATION, \$26M Student Center Renovation (opened in phases January and August 2015).

SHW GROUP, Berkley, MI

June 1998 – April 2006

Project Coordination Services, Detroit Public Schools (January 2001-April, 2006)

As part of the DPS Program Management Team (DPSPMT) on the \$1.5 Billion Bond Program, provided architectural oversight for the district with attention to program goals, design standards and document deliverables.

- Managed Design consultants throughout lifecycle of each project; evaluated proposals, administered contracts, and monitored performance. Owner representative on LEED certification for Detroit School of Arts.
- Participated in planning/programming activities including site assessment, scope, cost, schedules and project implementation plan development.

Project Architect, (June 1998 - January 2001)

Developed designs and technical documentation on educational projects including Student/Conference Centers, Physical Plant Improvements and other educational campus facilities renovation programs.

OTHER EXPERIENCE

City of Ferndale Planning Commission, Planning Commissioner (2003-present)

- Involved in zoning ordinance updates, Master Plan updates and Development Capital Improvement Plan.
- Chaired Planning Commission from 2007-2008.

Baker College of Allen Park, Adjunct Faculty (September 2010- present)

- Instruct in Architectural/Construction Technology program. Introduce the basic concepts of architectural drafting and design, preliminary design considerations and construction techniques, Building code and sustainable construction.

Continuing Education and Seminars:

- Change Order Management
- CPTED (Crime Prevention Through Environmental Design)
- Dispute Resolution
- Continuing education development in business, desktop and management studies

Kevin Shultis, AIA, LEED AP

Vice President



Kevin Shultis is the leader of SmithGroupJJR's Cultural Practice. A registered architect with over 30 years of design and management experience, he has an earned reputation for outstanding work in cultural and higher education facilities. He has special expertise in the programming, planning and design fine art and interpretive museums, professional schools for the arts, and collection care facilities. He brings a unique understanding of and perspective to art-centric facility design and is especially skilled in the integration of learning environments. Shultis' clients include the Cranbrook Educational Community, Flint Cultural Center, Howard University, Kemper Institute of Contemporary Art, Northwestern University, Ohio State University, University of Michigan West Virginia University, University of Michigan, University of Turin (Italy), Western Michigan University, and YMCA of Metropolitan Detroit.

Education

Bachelor of Science in Architecture
University of Michigan, 1979

Master of Science in Architecture
University of Michigan, 1981

Registrations

Registered Architect: Michigan

LEED Accredited Professional

National Council of Architectural Registration
Boards

Affiliations

American Institute of Architects

Society of College and University Planners

National Association of Corporate Real Estate
Executives

Chairman, AIA Michigan Government Affairs
Committee

**Central Michigan University Art,
Gallery Study, Mount Pleasant,
Michigan**

**Cranbrook Museum and Library
Climate Control and Collections
Protection, Bloomfield Hills,
Michigan**

**Florida Museum of Natural History,
Master Plan, Gainesville, Florida**

**Flint Cultural Center, Sloan Long-
way Museum, Flint, Michigan**

**Indian Springs Metropark James
Clarkson Environmental Discovery
Center, Springfield Township,
Michigan**

**Muskegon Museum of Art Expan-
sion/Renovation, Muskegon,
Michigan**

**National Hurricane Museum and
Science Center, Lake Charles and
Cameron, Louisiana**

**National Park Service, Keweenaw
Union Building, Calumet, Michigan**

**University of Michigan Literature
Science and Arts Renovation,
Ann Arbor, Michigan**

**University of Michigan Ruthven
Museum Building Dry Collections,
Ann Arbor, Michigan**

**University of Michigan William L.
Clements Library Renovation and
Addition, Ann Arbor, Michigan**

**West Virginia University Art
Museum and Rare Book Room,
Morgantown, West Virginia**

**Western Michigan University
Richmond Center for Visual Arts,
Kalamazoo, Michigan**

**Beaubian Place Mixed-Use Devel-
opment, Detroit, Michigan**

**Boll Family YMCA, Detroit, Michi-
gan**

**Braun, Kendrick & Finkbeiner, PLC,
Saginaw, Michigan**

Central Michigan University
Caponigro Multimedia Lab, Mount
Pleasant, Michigan

Central Michigan University
Herbert H. and Grace A. Dow Col-
lege of Health Professions, Mount
Pleasant, Michigan

Central Michigan University Rose
Arena Feasibility Study, Mount
Pleasant, Michigan

Detroit Athletic Club Master Plan,
Detroit, Michigan

Detroit Athletic Club Renovation,
Detroit, Michigan

Edsel and Eleanor Ford House
North Development Zone Projects,
Grosse Pointe, Michigan

Michigan State University, Mary
Mayo Hall, East Lansing, Michigan

Taylor Place: Arizona State Uni-
versity Downtown Residence Hall,
Phoenix, Arizona

University of Detroit Mercy School
of Dentistry, Detroit, Michigan

University of Michigan Horace
H. Rackham School of Graduate
Studies - Program Analysis,
Ann Arbor, Michigan

University of Michigan Horace
H. Rackham School of Graduate
Studies Infrastructure Study,
Ann Arbor, Michigan

University of Michigan Lawyers
Club Renovation Ann Arbor,
Michigan

Western Michigan University Col-
lege of Health and Human Services,
Kalamazoo, Michigan

Western Michigan Univer-
sity Frostic School of Visual Arts,
Kohrman Hall Renovation, Kalama-
zoo, Michigan

William & Marie Carls Family YMCA,
Milford, Michigan

University of Michigan Flint
Classroom/Laboratory Building,
Flint, Michigan

University of Michigan Francois-
Xavier Bagnoud Aerospace
Engineering Building, Ann Arbor,
Michigan

University of Michigan Horace
H. Rackham School of Graduate
Studies Infrastructure Study,
Ann Arbor, Michigan

Veterans Benefits Administration
Regional Office, Chicago, Illinois

Visteon Village, Corporate Head-
quarters, Van Buren Township,
Michigan

Western Michigan University Col-
lege of Health and Human Services,
Kalamazoo, Michigan

Western Michigan University
Recreational System, Kalamazoo,
Michigan

William & Marie Carls Family YMCA,
Milford, Michigan

Young & Rubicam, Dearborn,
Michigan

Presentations

- American Association of
Museums, 2012, "Changing
Conservation Environment
Guidelines and their Impact on
Today's Museums"

Awards and Honors

- AIAMI Hastings Award 2008
- AIAMI Architects Political Action
Steering Committee Chairperson
2014-Present
- AIAMI Government Affairs Com-
mittee Chairperson 2006-2013

Frank Boles
vita (abridged)

Clarke Historical Library
Central Michigan University
Mount Pleasant, MI 48859

voice: (989) 774-3352 fax: (989) 774-2160 email:frank.j.boles@cmich.edu

Education

- Ph.D. University of Michigan, Ann Arbor, 1990
- M.A. Wayne State University, Detroit (minor in archival administration), 1977
- B.A. Wayne State University, Detroit, 1974

Archival Work Experience

August 1991-Present

- Director, Clarke Historical Library, Central Michigan University, Mount Pleasant

January 1982-August 1983; July 1984-July 1991

- Bentley Historical Library, University of Michigan, Ann Arbor, serving as associate archivist for electronic records (1988-91, .5fte position); assistant archivist for university records (1982-88) and acting university records field representative (1985-86)

September 1983-June 1984

- Program Officer, National Endowment for the Humanities, Washington, D.C. (while on leave of absence from the University of Michigan)

May 1981-December 1981

- Project archivist, Chicago Historical Society, Chicago

Publications

- Two monographs, *Archival Appraisal* (New York: Neal-Schuman Publishers, 1991), and *Selecting and Appraising Archives and Manuscripts* (Chicago: Society of American Archivists, 2005); ten juried articles published in *American Archivist*, *Archival Issues*, *Detroit in Perspective*, *Provenance* and *the Revue Suisse d'Histoire*.

Presentations

- Over forty-five invited presentations from 1978 to 2011 given in the United States, Canada, Spain, and Austria.

Teaching Experience

September 1985-1991

- Appointed lecturer with responsibility for teaching all archival courses, School of Information, University of Michigan (became .5 fte position in 1988)

Professional Activities

Society of American Archivists

- Chair, Committee on Advocacy and Public Policy, 2011-current
- President, 2008-09
- Vice-President (elected position) 2007-08
- Council (elected position), 2002-2005
- Education Officer Search Committee, 1996
- Education Office Advisory Board (1994-1997), chair 1996-1997
- Nominating Committee Candidate (elected position), 1993
- Committee on Education and Professional Development, 1990-1994, chair 1992-1993, co-chair, 1993-1994

Midwest Archives Conference

- President (elected position), 1999-2001
- Co-chair, Spring 1997 Program Committee (25th Anniversary Meeting)
- Council Member (elected position) 1988-1990
- Editorial Board, 1987-1993, chair 1989-1991
- Nominating Committee (elected position), 1986-1987

Michigan Archival Association

- President, 1992-1994
- Vice-President, 1990-1992
- Executive Board Coordinator (acting President), 1988

State Appointments

- Michigan State Historic Records Advisory Board (current member, governor's appointment)

Awards

Fellow, Society of American Archivists, 1997
Phi Beta Kappa, 1974

NANCY W. BARR

Residence: 218 E. Cambourne St., Ferndale, Michigan, 48220

Office: The Detroit Institute of Arts, Department of Prints, Drawings and Photographs

5200 Woodward Ave., Detroit, Michigan, 48202, Tel.: 313.833.9833, Fax: 313.833.8629

Email: nbarr@dia.org; Mobile: 248.227.3329

EDUCATION

MA, Art History, Wayne State University, Detroit, Michigan, 1994.

BFA, Photography, College for Creative Studies, Detroit, Michigan, 1984.

Specialized Graduate Coursework and Practicum

- MLIS Candidate, Information and Library Science, Wayne State University, Detroit, Michigan, 1994-97.
- Certificate, Archival Administration, Information and Library Science, Wayne State University, Detroit, Michigan, 1996.

PROFESSIONAL EXPERIENCE

Co-Chief Curator, 2013 to present, The Detroit Institute of Arts, Detroit, Michigan.

Interim Dept. Head, 2015, James Pearson Duffy Department of Contemporary Art. The Detroit Institute of Arts, Detroit, Michigan.

Curator of Photography, 2013 to present, **Associate Curator**, 2005–13, **Assistant Curator**, 1996–2005, **Intern**, 1994–96, Department of Prints, Drawings and Photographs, The Detroit Institute of Arts, Detroit, Michigan.

Adjunct Lecturer, 2008–09; University of Michigan, Department of Art History, Dearborn, Michigan.

Adjunct Instructor, 2004–05; The College for Creative Studies, Department of Photography, Detroit, Michigan.

EXHIBITIONS

Curator: *Photographs from the Detroit Walk-In Portrait Studio by Corine Vermeulen*, (artist commission and exhibition), November 14, 2014 – May 17, 2013.

Curator: *Detroit – Bruce Weber*. The Detroit Institute of Arts, June 20 – September 7, 2014.

Curator: *Foto Europa, 1850 to the Present*, The Detroit Institute of Arts, October 25, 2013 – April 17, 2013.

Curator: *Motor City Muse: Detroit Photographs, Then and Now*, The Detroit Institute of Arts, December 14, 2012 – June 16, 2013.

Curator, *Detroit Revealed: Photographs, 2000-2010*. The Detroit Institute Arts, 2011.

Co-Curator, *An Intuitive Eye: André Kertész Photographs 1914-69*. The Detroit Institute of Arts, 2010-11.

Curator, Detroit Experiences: Robert Frank Photographs 1955, The Detroit Institute of Arts, 2010.

Curator, *Photography - The First 100 Years: Photographs from the DIA's Collection*, The Detroit Institute of Arts, 2009.

Curator, *In the Company of Artists: Portraits from the DIA's Collection*, The Detroit Institute of Arts, 2008.

Curator, *Dawoud Bey: Detroit Portraits* (residency and exhibition), The Detroit Institute of Arts, 2004.

Co-Curator, *Fresh: Youth Culture in Contemporary Photographs*, The Center for Photography, Woodstock, New York, 2004.

PUBLICATIONS

Contributor, “**Detroit Unbroken Down**” from *Detroit Unbroken Down: Photographs by Dave Jordano*. Essay contribution. Powerhouse Books, 2015.

Managing Editor and Contributor: *Photographs from the Detroit Walk-In Portrait Studio by Corine Vermeulen*. Exhibition publication with interview and checklist, 2014.

Contributor: “**On Artistry, Advocacy and Influence – Bill Rauhauser and the Photographic Tradition in Detroit**” from *Bill Rauhauser 2014 Kresge Eminent Artist*. Monograph with essay, Kresge Foundation, 2014.

- Contributor: **"Here's Looking at You Bruce Weber – from Detroit with Love"** from *Bruce Weber: Detroit Has Been Good to Me*. Exhibition publication including essay contribution, Little Bear Studios, 2014.
- Author: **"Mapping the Muse: What Is Photographic Practice in Detroit?"** from *Motor City Muse: Detroit Photographs, Then and Now*. Exhibition catalogue including essay and checklist, Detroit Institute of Arts, 2013.
- Contributor: **"Identity Management: Photography and 21st Century Detroit,"** *Detroit Revealed: Photographs, 2000-2010*. Exhibition catalogue with essay and checklist, Detroit Institute of Arts, October 2011.
- Author: ***Detroit Experiences: Robert Frank Photographs, 1955***. Exhibition brochure essay and checklist, Detroit Institute of Arts, March 2011.
- Managing Editor: ***The Bulletin of the Detroit Institute of Arts: Photography***. Detroit Institute of Arts, July 2010.
- Author: **"The Pleasure of Looking, the Pleasure of Seeing: Sam Wagstaff and the Art of Collecting Photographs,"** *The Bulletin of the Detroit Institute of Arts*, July 2009.
- Author: **"The Legacy of Photographic Modernism in America: Edward Weston's "Photographic Art" and Charles Sheeler's *Wheels*."** *The Bulletin of the Detroit Institute of Arts*, July 2006.
- Contributor: ***Encyclopedia of Twentieth Century Photography***, entries for Herbert Bayer, John Coplans, George Hurrell, Joel Meyerowitz. Routledge, 2005.
- Author: **"Contemporary Photography and the Chronicles of Youth, 1993-2003,"** *Photography Quarterly* # 89, vol. 21, no. 4., 2004.
- Author: **"Motor City Muse: Robert Frank in Detroit,"** *Big*, August 2003.
- Author: **"Memory, Truth, and the American Working Class City: Robert Frank in Detroit and at the Rouge,"** *The Bulletin of the Detroit Institute of Arts*, July 2002.
- Contributor: ***Masterpieces from The Detroit Institute of Arts***, exhibition catalogue, entries for George Grosz, Henri Matisse, Pierre-Auguste Renoir, Christian Rohlf, Karl Schmidt-Rottluff, Suzanne Valadon, White Public Relations Co., Ltd., 2001.

LECTURES AND SPEAKING ENGAGEMENTS

- Lecture: **"Motor City Muse: Photographic Traditions in Detroit."** Lorenzo Art Center, Macomb Community College, 2014.
- Panel moderator: **"Outsiders Looking In (with Jerry Herron, Karin Jobst, Nadja Rottner)."** The Detroit Institute of Arts, March, 2013.
- Presenter and panel participant: **"Looking Through Photographs (with Chris Edwards, Brenda Pelkey, Kenneth Montague, Phil Bergerson)."** Art Gallery of Windsor, Windsor, Ontario, Canada, June 2012.
- Lecture: **"Detroit, Urban Iconography, and the Photograph, 1927-2010."** Eastern Michigan University, Ypsilanti, Michigan, February 2012.
- Panel moderator: **"Perspectives on Photography: Detroit (with Michelle Andonian, Carlos Diaz, Scott Hocking and Carlo McCormick)."** The Detroit Institute of Arts, March 2012.
- Panel moderator: **"Perspectives on Photography: Authenticity, Invention, and Image (with Michelle Andonian, Sara Blair, Cary Loren, Corine Vermeulen, and Len Walle)."** The Detroit Institute of Arts, May 2011.
- Lecture: **"Art, Life, Science and the Nature of Perception in Recent Work by Doug and Mike Starn,"** Chicago Humanities Festival, Chicago, Illinois, 2008.
- Keynote Address: **"Toward a Radical Consciousness: The Role of Photography and Social Awareness."** Society for Photographic Educators, Flint Institute of Arts, Flint, Michigan, November 2007.
- Lecture: **"Beyond Big: Contemporary Art and the Emergence of Large Scale Color Photography."** Columbia College, Chicago, November 2005.
- Lecture: **"Robert Frank and the Working Class Culture of Detroit."** Michigan State University, Lansing, October 2005.
- Lecture/talk with Dawoud Bey: **"Dialogue with Dawoud Bey."** The Detroit Institute of Arts, April 2004.

Leslie S. Edwards

82 Woodward Heights, Pleasant Ridge, MI 48069
248-259-7983
ledwards@cranbrook.edu

EDUCATION

Wayne State University, Detroit, MI, December 2000
Masters of Library and Information Science
Graduate Certificate in Archival Administration

Michigan State University, East Lansing, MI, June 1979
Bachelor of Arts in Art Education, Emphasis in Metalsmithing

PROFESSIONAL EXPERIENCE

Head Archivist, Cranbrook Archives, Cranbrook Educational Community, Bloomfield Hills, MI, Jan 2012 to present

Interim Director, Cranbrook Archives and Cultural Properties, Cranbrook Educational Community, Bloomfield Hills, MI, Aug 2008 to Jan 2012

Archivist, Cranbrook Archives, Cranbrook Educational Community Bloomfield Hills, MI, Jul 2002 to Aug 2008

Director, Oakland County Pioneer & Historical Society, Pontiac, MI, Jul 1999 to Jul 2002

Technology Librarian, Southfield Public Library, Southfield, MI, 1998 to 1999

PROFESSIONAL SERVICE

Participant, Wayne State University's Public History Stakeholder's Workshop, Wayne State University, 2015

Exhibition Research Consultant, "Michigan Modern: Design that Shaped America," Cranbrook Art Museum, Bloomfield Hills, MI, 2013

Exhibition Research Consultant, "Vision and Interpretation: Building Cranbrook, 1904–2012," Cranbrook Art Museum, Bloomfield Hills, MI, 2012

Consultant, *The Place Where the Crooked Tree Stood*, (Goodhart, MI: The Crooked Tree Book Company, 2012)

Member, Strategic Planning Committee, Birmingham Historical Museum, Birmingham, MI, Oct 2012

Grant Reviewer, National Historical Publications & Records Commission, Washington, DC, Feb 2012

Local Arrangements Coordinator, "Scrapbooks: Care, Preservation, and Access," Midwest Archives Conference 2007 Fall Symposium, Cranbrook Educational Community, Bloomfield Hills, MI, Oct 2007

Researcher, Historical Records Inventory, Association for the Preservation of Ontario Land Registry Office Documents, Ontario, Canada, 1998

SELECTED WRITINGS AND PRESENTATIONS

- “Feminizing Alcoa Aluminum: Marianne Strengell and the Forecast Rug,” with Barbara Paris Gifford, *Journal of Modern Craft*. Bloomsbury Publishing (2015).
- “Jayne Van Alstyne and Clay: Pottery and Design,” *O Pioneers! Women Ceramic Artists, 1925-1960*. Alfred Ceramic Museum (2015).
- “Crafting Modernism: The Cranbrook Connection,” *Always Seeking Modern*, Michigan Historic Preservation Network’s Thirty-Fifth Annual Statewide Preservation Conference, Midland, MI, May 13-16, 2015.
- “Designing Nature,” *My Brain is in My Inskstand: Drawing as Thinking and Process*. Cranbrook Art Museum (2014): 100-101.
- “Collaboration, Connection and Competition: Cranbrook 1939,” *Michigan Modern: Design that Shaped America, A Symposium*, Michigan State Historic Preservation Office in conjunction with Cranbrook Educational Community, Bloomfield Hills, MI, June 13-16, 2013.
- “Crafting Networks: Detroit’s Role in the Building of Cranbrook,” *Society of Architectural Historians 65th Annual Conference*, Detroit, MI, April 18-22, 2012.
- “The Waters of Cranbrook,” with Lisa Apel and Jean-Claude Azar, Cranbrook Educational Community, Bloomfield Hills, MI, June 2011
- “Cross-Pollination and the ‘Three Fates’: Bringing Arts and Crafts to Detroit,” *Useful & Beautiful: The Transatlantic Arts of William Morris and the Pre-Raphaelites*, University of Delaware, Newark, DE, October 7-9, 2010.
- “Structure and Surface: Marianne Strengell and Woven Texture,” *Modernism Magazine*, Vol. 10, No. 4, (Winter 2007-08): 76-85.

HISTORICAL SERVICES CONSULTANT

City of Bloomfield Hills, Bloomfield Hills, MI
Franklin Historical Society, Franklin, MI
Ferndale Historical Museum, Ferndale, MI
Oakland County Pioneer and Historical Society, Pontiac, MI
Private Clients, Metro-Detroit area
Wolverine Lake Dam Project, Wolverine Lake, MI

PROFESSIONAL AFFILIATIONS

Society of American Archivists, member
Midwest Archives Conference, member
Michigan Archival Association, member

Roberta Frey Gilboe
129 Crane Avenue
Royal Oak, MI 48067
Cell: 248-797-7856
Email: rgilboe@sbcglobal.net

Academic Qualifications:

B.A. in History and Classics
Honors College
Michigan State University
Magna cum Laude
Phi Beta Kappa

M.A. in Museum Studies
University College London
University of London
Internship with the Royal Armouries, at the
Tower of London

Current Position:

2014 to present **University of Michigan Museum of Art**
Chief Registrar, Collections and Exhibitions

- Management of the movement and inventory of all of Art Museum collections.
- Work closely with the Curatorial and Education staff to make collections available for educational programs, students, faculty, and researchers.
- Oversight of storage for an encyclopedic collection of works that includes a large collection of prints and photographs.
- Coordination with the Facility Manager to insure that climate control is consistent in the spaces where art is stored and displayed.
- Guide the long-term planning for developing new storage solutions and housing for Art Museum collections,
- Supervision of the Techs, the Assistant Registrar, and for staff hired for exhibition installation projects.
- Management of the logistics of all exhibitions and loans to and from the Art Museum.
- Management of all accessions and deaccessions for the Art Museum.
- Management of the collections management database system used for the Art Museum collections, including training personnel, insuring data entry consistency, and developing its use as an educational tool.

Relevant Experience:

1999 to 2014 **Cranbrook Art Museum and Cranbrook Center for Collections and Research**
Head Registrar

- *Collections Storage Project:* While at Cranbrook, in addition to managing collections, loans, and exhibitions, I participated in the planning and implementation of the Art Museum's new collections storage wing, which opened in 2011. I was involved in every facet of the planning

process, working with Smith Group to discuss the needs of the collection and develop storage that would serve the needs of a varied collection that included a significant number of works on paper. The final result of that project was a paper study/storage room that allowed the Art Museum staff to rehouse the works on paper collection in a climate-controlled environment with efficient and accessible storage to allow for its use by curators, educational programming, and researchers.

1993-1999 **Detroit Institute of Arts (DIA)**
Senior Registrar

- *Database Responsibilities:* When the DIA acquired a new database program to manage collections, my role was to thoroughly test all new elements in the database system and verify the data. This required extensive and ongoing work with the database vendor to develop the new database and fulfill the original RFP specifications. Organized and supervised a data entry project to enter basic information for 11,000 backlogged records. Documented data content, cataloging, and procedural rules for the museum's database program. Provided ongoing support and training for all users of the database program.
- *Accessioning:* Assembling and organizing documentation, maintaining all files concerning the accessioning process, arranging shipping for objects, including international shipping, frequent contact with donors, dealers and artists, condition reporting, reporting to the various committees that process accessions, entering and verifying computer records concerning accessions.
- *Deaccessioning:* Record-keeping and reporting for all deaccessioned items, researching and verifying title, assembling and organizing documentation, packing and shipping arrangements, condition reporting, tracking objects when they arrived at the auction house, reporting on sales of objects and reporting the final results to accounting and the Collections Committee. Documented the deaccession process and created new forms to streamline procedures.
- *Other Responsibilities:* Managed exhibitions, couriered art objects by truck within the United States and Canada and internationally by truck and cargo plane.

1992-1993 **Historic New Orleans Collection**
Curatorial Cataloguing Coordinator

- *Documentation Responsibilities:* Established and documented data content, cataloging rules, and procedural standards for the collections database. Projects included writing a data dictionary to document the procedures used for entering data and organizing standard procedures for new item cataloging. Worked with the Library, Manuscripts, and Systems Departments to establish consistency in the documentation and data entry throughout the institution.
- *Cataloging and Computer Responsibilities:* Data entry and the responsibility for maintaining the consistency of curatorial data entry by other users of the Quixis collections management database. Reviewed and assessed the backlog of uncataloged records. Responsible for general database review and cleanup.